



# *Australia's biggest Theme Park & Hotel*

Global Heritage City  
*with 20 concept areas*

*City of Moreton Bay, Queensland, Australia*



*A once in a generation opportunity* for Australia and Southeast Queensland to create an entertainment and cultural complex to *bring the world to Australia* and *Australia to the world*.







Delivering *global experiences* to visitors to  
*increase tourism*, economic development and  
community engagement in City of Moreton Bay, by providing a  
*unique and immersive* experience.



A group of diverse children, including girls and boys of various ethnicities, are laughing joyfully. The image is overlaid with a semi-transparent orange banner containing text. The text is in a mix of green and white colors, with some words in italics. The background is a warm, golden light, suggesting an outdoor setting.

*Teaching new generations,*  
the importance of *culture and heritage*, through  
showcasing our past, how things happened, and  
what may happen *in the future.*

# THE *Location*





# LAND Search Land

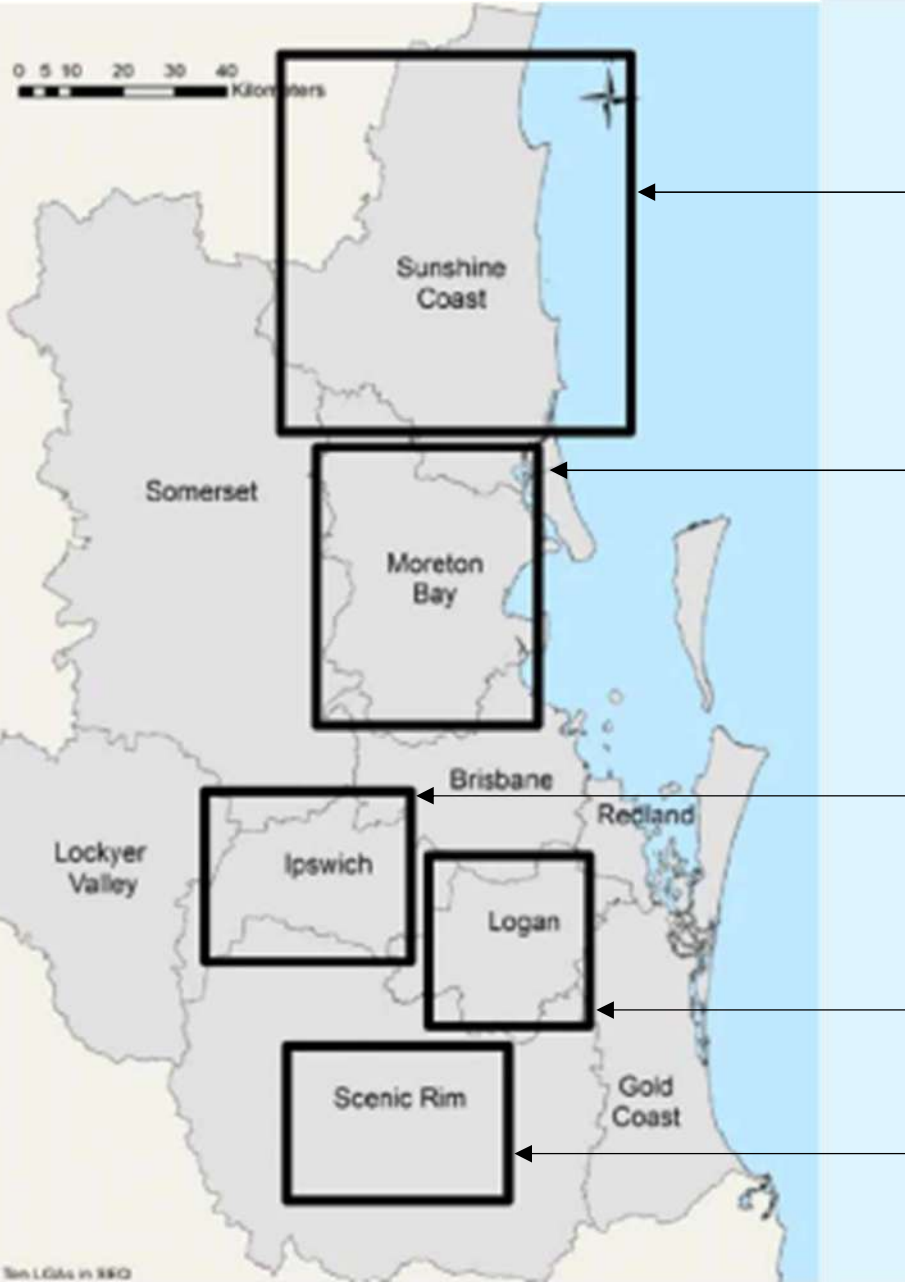

**Sunshine Coast Council**  
Big Pineapple Parcels  
Twin Waters Parcels

**City of Moreton Bay**  
Elimbah East A  
Elimbah East B  
Elimbah North  
North Harbour

**Ipswich City Council**  
Boonah Road Interchange /  
Cunningham Highway  
Ebenezer Regional  
Industrial Area –  
Willowbank Industrial Park  
Ebenezer Regional  
Industrial Precinct

**Logan City Council**  
Park Ridge Carbrook  
Cedar Grove

**Scenic Rim**





# LAND *City of Moreton Bay*

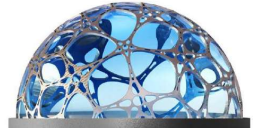

**INFINITY PLANET**  
Global Heritage City - Queensland, Australia

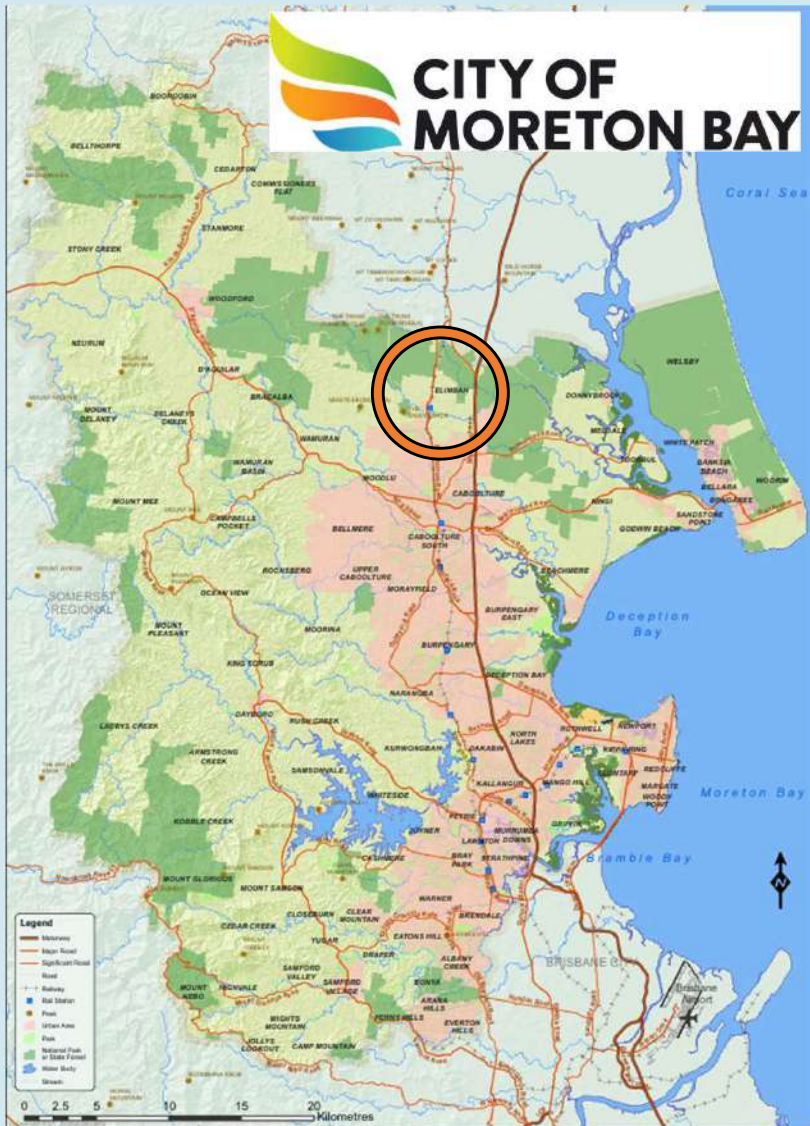



# ELIMBAH *City of Moreton Bay*

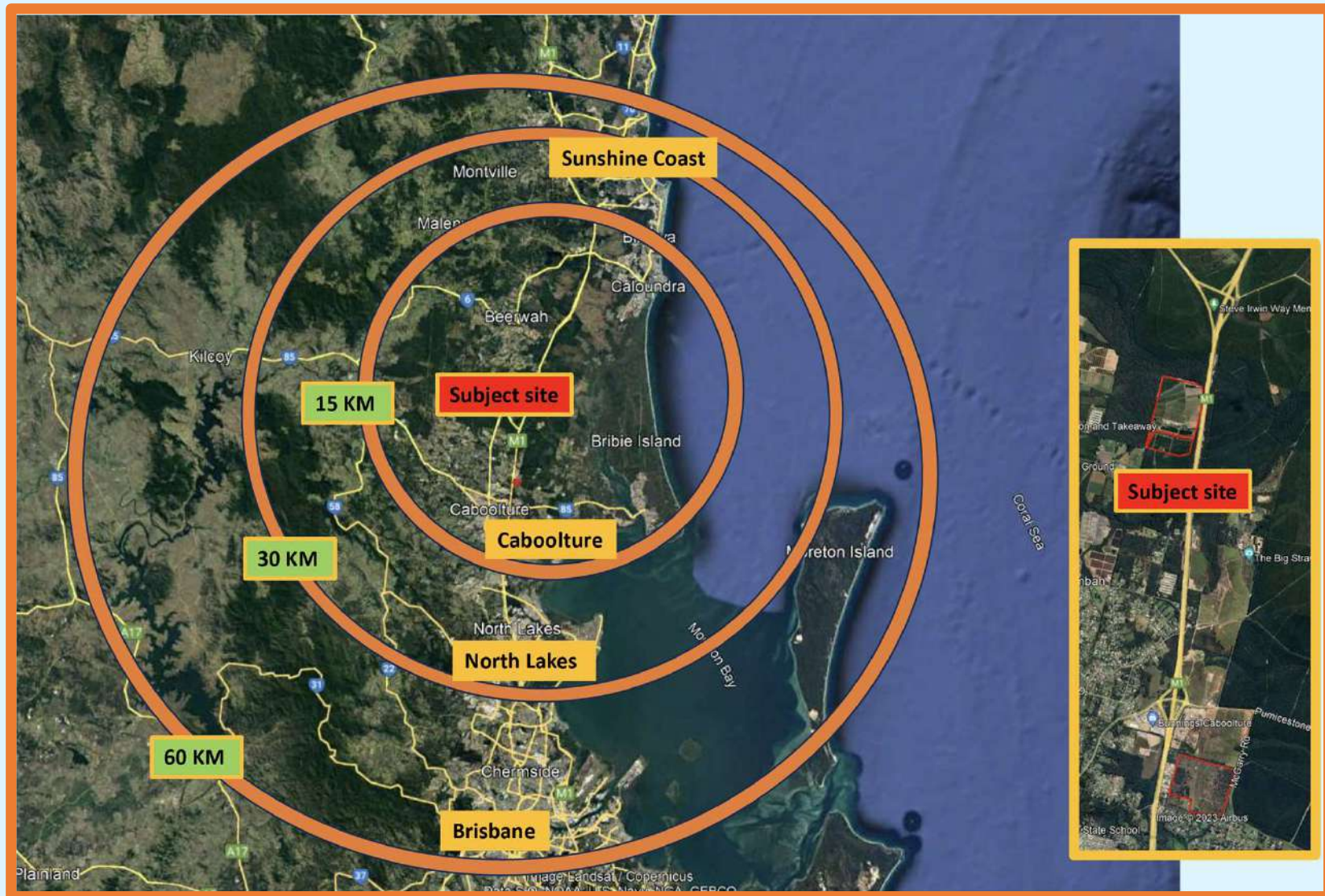



While the subject site has positively been included in the Urban Footprint in the latest regional plan, **it has also been included in a newly created SEQ development area.**

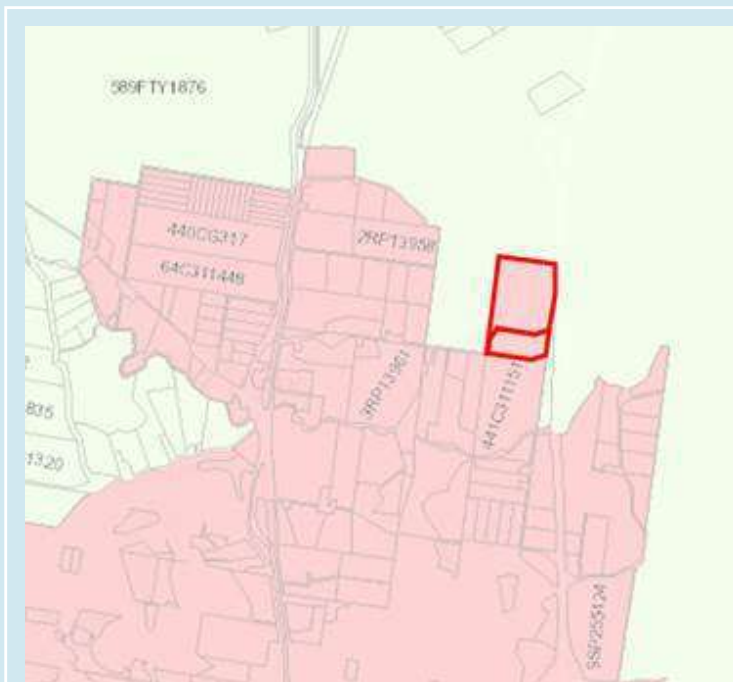

Location of land **within Urban Footprint**

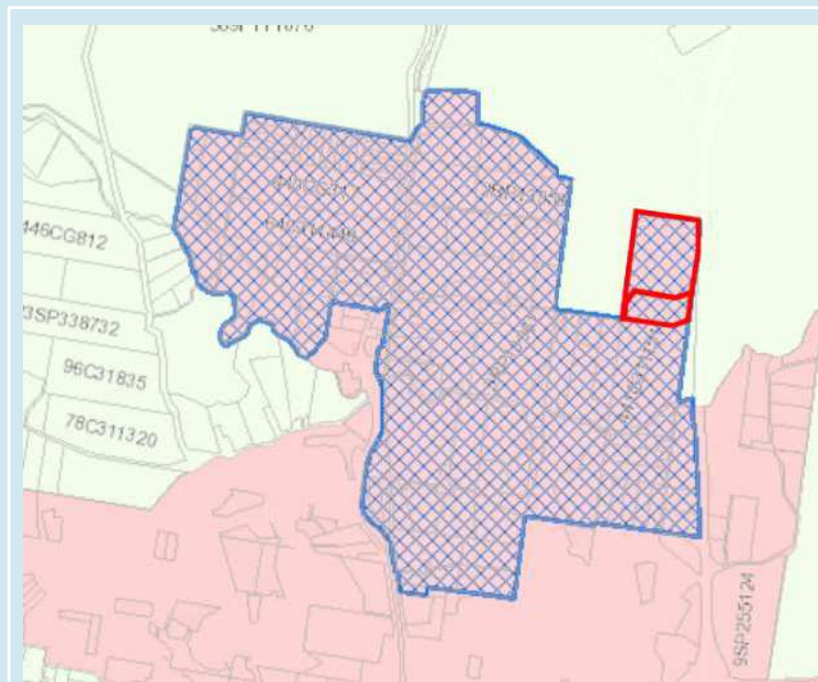

Location of land **within SEQ development area**



# LAND *New City Center*

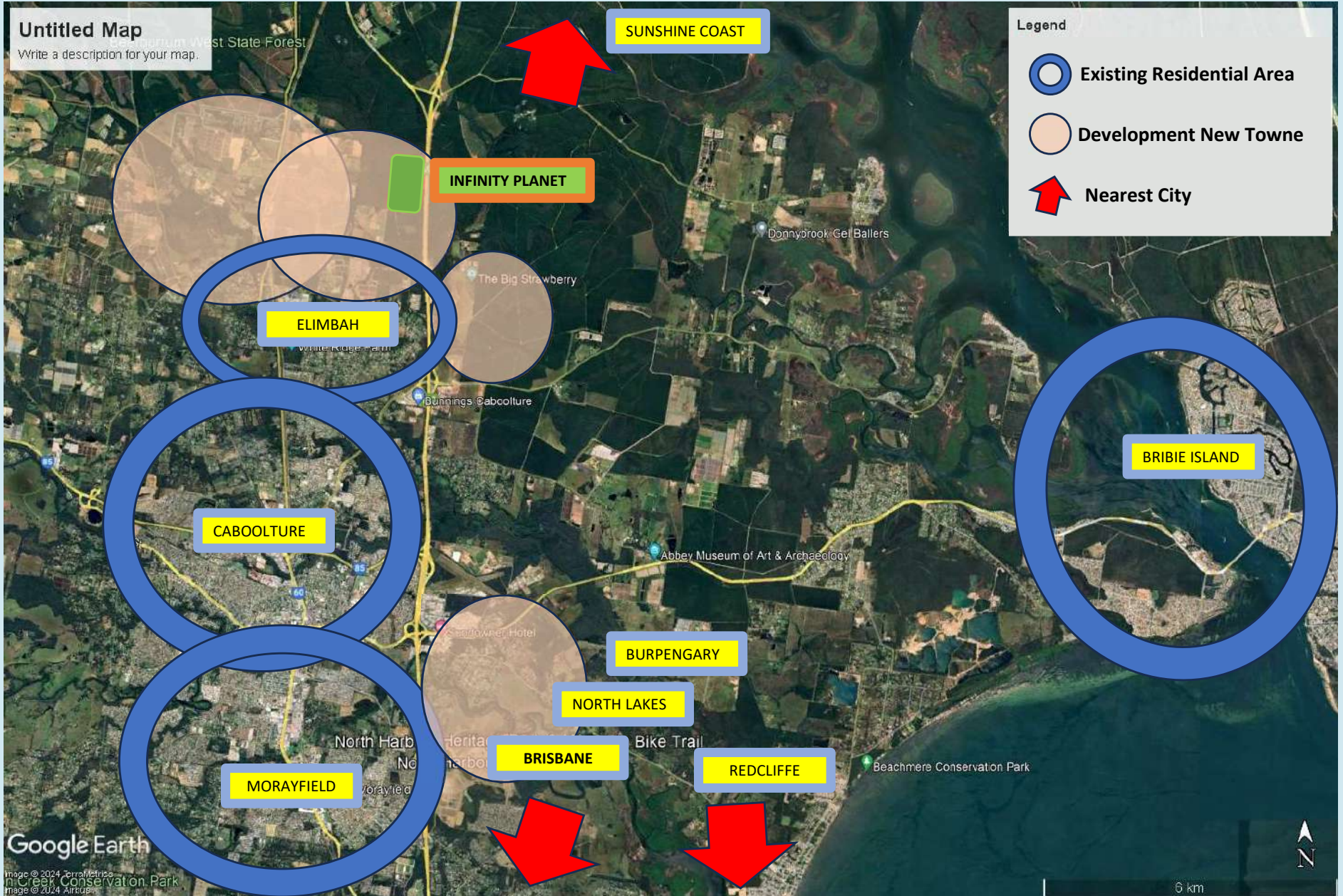



# MASTER PLAN *Elimbah North*



**235 & 245 Bartholomew Road, Elimbah**

**680,000 sq.m or 7,319,000 sq.f**





# **THE** *Scale*





# SCALE OF *Infinity Planet*



Theme Park	Ha.	2019 Visitation	Global Rank
Magic Kingdom (Orlando, Florida)	43	20.9M	1
<i>Infinity Planet (proposed)</i>	<b>68</b>		
Disney (Anaheim California)	40	18.7M	2
Disneyland Park (Paris)	57	9.7M	14
Tokyo Disneyland	47	17.9M	3



# SCALE OF *Infinity Planet*



Theme Park	Ha.	2019 Visitation	Global Rank
Magic Kingdom (Orlando, Florida)	43	20.9M	1
<i>Infinity Planet (proposed)</i>	<b>68</b>		
Disney (Anaheim California)	40	18.7M	2
Disneyland Park (Paris)	57	9.7M	14
Tokyo Disneyland	47	17.9M	3



# SCALE OF *Infinity Planet*



Park	Land Area (Ha.)
South Bank Parklands	9.7
Sea World	21.8
Wet 'n Wild	13.2
<i>Infinity Planet Land Holding</i>	<i>68.1</i>
Dreamworld	14.3
WhiteWater World	8.1

**Infinity Planet is equivalent of adding together the footprint of South Bank Parklands, Sea World, Wet 'n' Wild, Dreamworld and WhiteWater World. (Totalling 67.1 Ha)**



# SCALE OF *Infinity Planet*

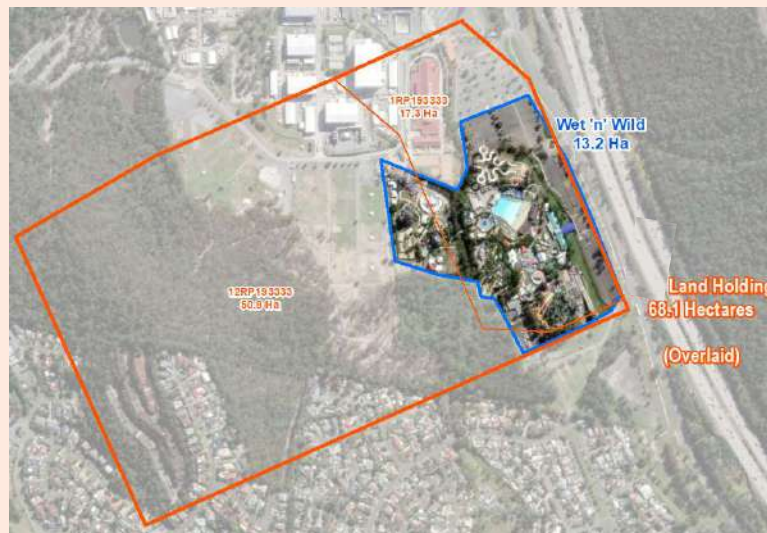

Infinity Planet (IPC) land (68.1HA) is the equivalent of all 5 Gold Coast theme parks (57HA) plus 10HA of car parking.





# **THE** *Entertainment Capacity*





# **INDOOR** Entertainment Centre



## Infinity Planet Entertainment Hub: 10,000 capacity

Compared to major existing Queensland venues



Source: [austadiums.com](http://austadiums.com)





# **POTENTIAL** *Olympics Venue*



## 2032 Olympics Venue: seating capacity for events



Source: <https://q2032.au/plans/venues-and-villages>





**Infinity Planet has 75% more carparks** than the combined total of carparks of Dreamworld, WhiteWater World, Sea World, Wet 'n' Wild and Movie World.

## Infinity Planet Carparks

*Compared to the big four theme parks on Gold Coast*

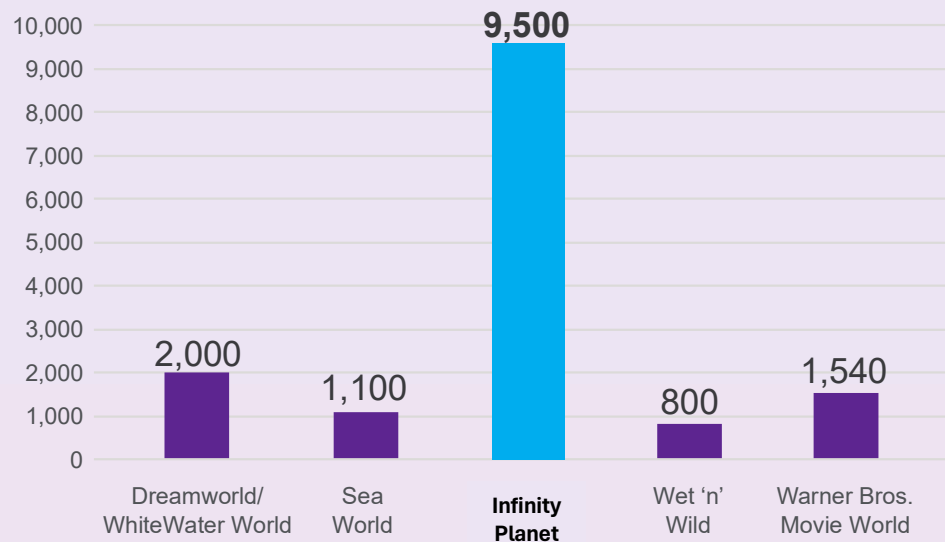

*Source: Estimated from aerial imagery (Google Maps)*





HOTEL AND *Accommodation*





# HOTEL AND *Accommodation*



*Infinity Planet will include **2,943 rooms** of short-term accommodation.*

Moreton Bay and Sunshine Coast have each identified a **total demand for 3,195 accommodation rooms needed before the 2032 Olympics.**

Infinity Planet **will absorb 92% of this demand** but will also generate additional demand beyond these demand studies as a consequence of creating one of the largest attractions in Australia.

*(Moreton Bay Hotel Investment Guide - 1,395 rooms, Sunshine Coast Hotel Prospectus - 1,800 rooms)*

***2,943 rooms of accommodation** in a concentration such as this, under one operator, exists nowhere in Australia.*

The closest comparison is the Crown Complex of separate hotels totalling 1,605 rooms.





# HOTEL AND *Accommodation*



If grouped as one accommodation provider, Infinity Planet comes close to *being in the top 30 largest hotels in the world*

*(by number of rooms).*

- **Number 29 in the world is Infinity Planet, City of Moreton Bay (2,943 rooms)**
- **Number 28 in the world is The Venetian Macao (3,000 Rooms)**
- **Number 27 in the world is The Cosmopolitan, Las Vegas (3,027 rooms)**
- **Number 26 in the world is The Mirage, Las Vegas (3,044 rooms)**
- **Number 25 in the world is Disney's Port Orleans Resort (3,056 rooms)**



# HOTEL AND *Accommodation*



*This is the largest hotel in Australia and would be the 6<sup>th</sup> largest hotel in Europe.*

The hotel building itself also has four (4) star accommodation as part of one building complex totalling 1,428 rooms.

## *Largest hotels in Australia*

- 1. Infinity Planet, City of Moreton Bay (1,428 rooms)**
2. Hyatt Regency Sydney (878 rooms)
3. Towers of Chevron Renaissance, Gold Coast (707 Rooms)
4. Crown Metropol, Melbourne (658 Rooms)
5. Four Points Sheraton, Sydney (648 Rooms)
6. Jupiter's Hotel & Casino, Gold Coast (594 Rooms)
7. Hilton, Sydney (577 Rooms)
8. Shangri-La Hotel, Sydney (563 rooms)





# THE *Economic Impact*



## Building confidence to Queensland's Tourism industry

- ✓ Infinity Planet will bring confidence back to Queensland's tourism market.
- ✓ Infinity Planet will support infrastructure development, enhance amenities, and boost service quality, attracting more tourists and highly skilled talent.
- ✓ Infinity Planet's tourists will stimulate demand across the tourism supply chain, encouraging local businesses to expand and diversify their offerings, building resilience and mitigating risks associated with fluctuations in tourism trends.
- ✓ Infinity Planet will significantly drive investor confidence, fostering a new cycle of sustainable growth, innovation, and adaptability in Queensland's tourism sector, ultimately bolstering Queensland economic stability and attractiveness to further domestic and international investment.



## Construction phase



**\$5.67B**  
Output

(\$2.63B direct  
+ \$3.04B Indirect)



**\$1.95B**  
Value added (GRP)

(\$887.06M Direct  
+ \$ 1.07B Indirect)



**3,624**  
Local jobs (per year)

(1,624 Direct  
+ 1,999 Indirect)

**Infinity Planet Proposal - 13 Feb 2024 (based on jobs) in the Moreton Bay** is estimated **to inject \$2.63B of direct output into the local economy over 5 years**. This would lead to an uplift of \$887M in direct value added and support 1,624 direct local jobs per annum during the construction phase of the project.

From this direct expansion in the economy, it is anticipated that there would be flow-on effects into other related intermediate industries as well as increased new employee consumption expenditure. These combined flow-on effects are **estimated to generate an additional \$3.04B in output, \$1.07B in value-added and support another 1,999 indirect local jobs per year** during the construction phase of the project.

**The total estimated construction phase local impact is \$5.67B in output, \$1.95B in value-added (GRP), and 3,624 local jobs per annum over 5 years.**

## Construction phase (5-year period)

### Moreton Bay – Modelling the impact of adding \$2632.24M in Construction

Economic measure	Output (\$m)	Value-added (\$m)	Local Jobs (annual)	Residents jobs (annual)
<b>Impacts on Moreton Bay economy</b>	--	--	--	--
Direct impact on selected sector(s)	2,632.24	887.06	1,624	--
Industrial impact	2,480.23	793.71	1,406	--
Consumption impact	558.36	272.38	593	--
<b>Total impact on Moreton Bay economy</b>	<b>5,670.83</b>	<b>1,953.15</b>	<b>3,624</b>	<b>2,849</b>
<b>Multipliers</b>	--	--	--	--
Type 1 multiplier (direct and industrial)	1.94	1.89	1.87	--
Type 2 multiplier (direct, industrial and consumption)	2.15	2.20	2.23	--
<b>Impact on Queensland economy</b>	--	--	--	--
Total impact - Queensland outside Moreton Bay	1,479.57	688.95	1,089	1,781
<b>Total impact on Queensland economy</b>	<b>7,150.39</b>	<b>2,642.10</b>	<b>4,712</b>	<b>4,630</b>
<b>Impact on Australian economy</b>	--	--	--	--
Total impact outside Queensland economy	1,443.65	725.63	791	804
<b>Total impact on Australian economy</b>	<b>8,594.05</b>	<b>3,367.72</b>	<b>5,504</b>	<b>5,434</b>

Source: National Institute of Economic and Industry Research (NIEIR) ©2023. Compiled and presented in economy.id by .id (informed decisions). Note: All \$ values are expressed in 2019/20 base year dollar terms.

**Disclaimer:** This report has been generated for the City of Moreton Bay. It is provided for information purposes only. There can be no assurance that actual results will be consistent with any forecasts or estimates provided within the report. The information in this report and the report itself is subject to change without notice. The modelling used to generate estimates of economic impacts within the report is provided by National Institute of Economic & Industry Research (NIEIR). Neither the Council nor .id gives any warranty nor bears any liability whatsoever with respect to the correctness, accuracy, currency, completeness, or otherwise of the NIEIR model, or other content generated from it within this report.





# ECONOMIC *Impact*



## Construction phase – Employment by industry sector

### Moreton Bay – Modelling the impact on local jobs, of adding \$2632.24M in Construction

Industry sector (1-digit ANSIC)	Existing jobs in the Moreton Bay	Jobs created in the Moreton Bay (annual)	Jobs created outside of the Moreton Bay (annual)	Jobs created for the Moreton Bay residents (annual)
Agriculture, Forestry and Fishing	3,365	31.5	49.6	25.2
Mining	818	12.8	44.5	10.5
Manufacturing	10,399	244.0	165.3	192.2
Electricity, Gas, Water and Waste Services	1,511	18.5	36.2	15.1
Construction	18,213	2177.7	49.4	1643.6
Wholesale Trade	3,391	55.6	75.1	45.4
Retail Trade	21,730	240.9	190.1	199.2
Accommodation and Food Services	12,159	164.8	177.5	139.6
Transport, Postal and Warehousing	6,354	83.9	106.2	72.4
Information Media and Telecommunications	1,037	10.4	51.7	9.9
Financial and Insurance Services	2,968	46.0	140.2	40.1
Rental, Hiring and Real Estate Services	3,005	68.0	44.8	56.6
Professional, Scientific and Technical Services	6,986	141.9	250.1	121.5
Administrative and Support Services	5,179	91.8	81.2	75.5
Public Administration and Safety	6,501	12.5	35.3	11.0
Education and Training	17,117	65.3	109.7	53.3
Health Care and Social Assistance	28,451	61.0	139.0	52.7
Arts and Recreation Services	1,822	12.2	38.1	11.0
Other Services	7,832	85.0	94.4	74.1
<b>Total industries</b>	<b>158,837</b>	<b>3,624</b>	<b>1,878</b>	<b>2,849</b>

Source: National Institute of Economic and Industry Research (NIEIR) ©2023. Compiled and presented in economy.id by .id (informed decisions).



# ECONOMIC *Impact*



## Construction phase – Employment by industry sector

Moreton Bay – Modelling the impact on local jobs, of adding \$2632.24M in Construction

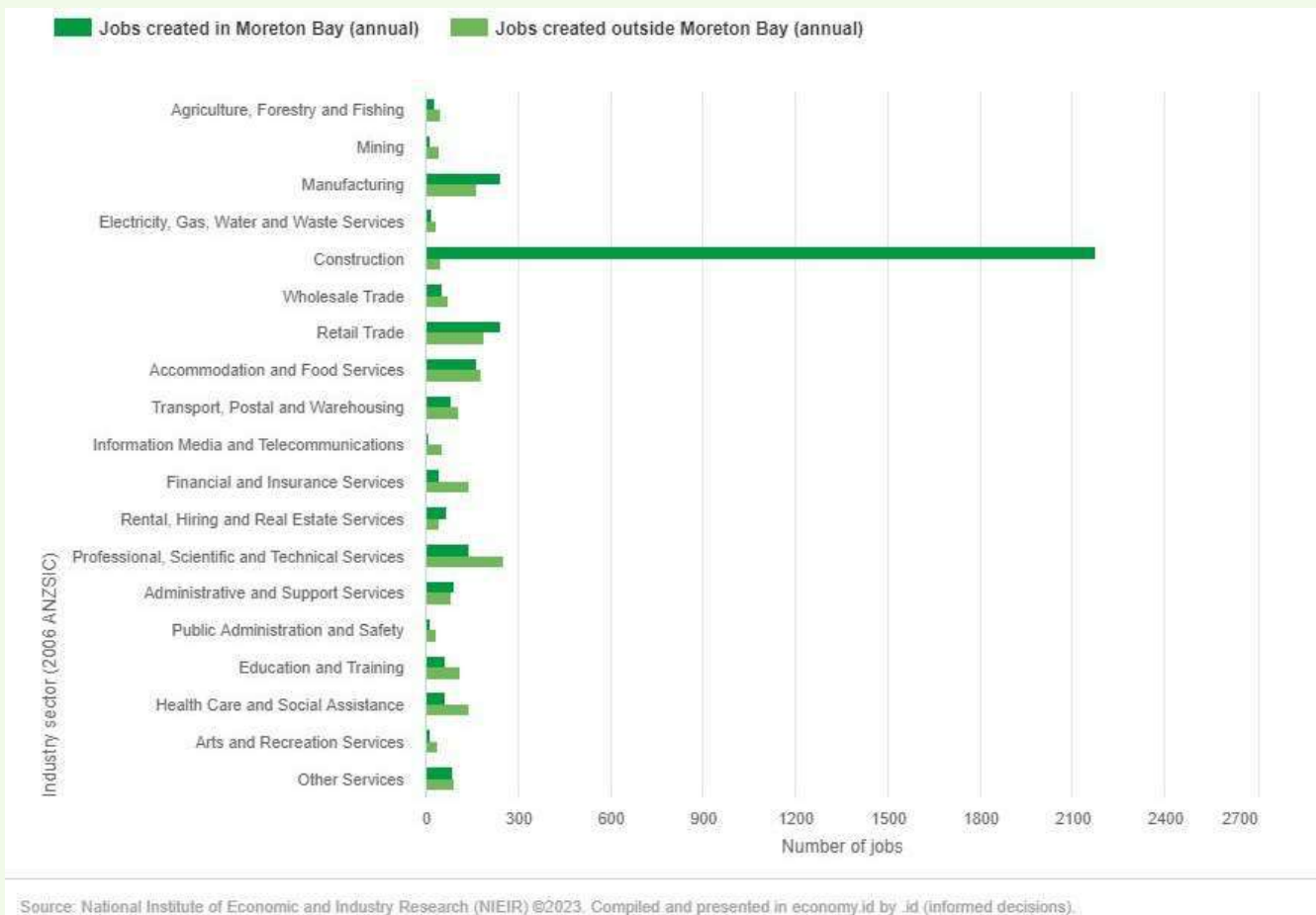

Source: National Institute of Economic and Industry Research (NIEIR) ©2023. Compiled and presented in economy.id by .id (informed decisions).





# ECONOMIC *Impact*



## Construction phase – Value added by industry sector

### Moreton Bay – Modelling the impact on value added of adding \$2632.24M in Construction

Industry sector (1-digit ANSIC)	Value Added \$m	Value added \$m to the Moreton Bay	Percentage change	Value added \$m to Australian economy
Agriculture, Forestry and Fishing	\$488.8	\$24.89	+5.09	\$70.64
Mining	\$84.8	\$3.87	+4.57	\$111.87
Manufacturing	\$1,227.5	\$170.53	+13.89	\$284.96
Electricity, Gas, Water and Waste Services	\$460.0	\$27.29	+5.93	\$80.18
Construction	\$2,010.2	\$1,150.57	+57.24	\$1,178.32
Wholesale Trade	\$622.5	\$51.74	+8.31	\$131.97
Retail Trade	\$1,497.3	\$82.78	+5.53	\$157.35
Accommodation and Food Services	\$499.1	\$34.21	+6.85	\$79.81
Transport, Postal and Warehousing	\$775.2	\$48.75	+6.29	\$131.74
Information Media and Telecommunications	\$155.6	\$9.69	+6.23	\$72.79
Financial and Insurance Services	\$722.6	\$57.37	+7.94	\$293.51
Rental, Hiring and Real Estate Services	\$632.6	\$70.40	+11.13	\$126.86
Professional, Scientific and Technical Services	\$869.9	\$86.62	+9.96	\$263.48
Administrative and Support Services	\$603.3	\$51.16	+8.48	\$124.94
Public Administration and Safety	\$724.8	\$6.84	+0.94	\$26.86
Education and Training	\$1,141.4	\$20.21	+1.77	\$68.08
Health Care and Social Assistance	\$2,189.2	\$22.56	+1.03	\$79.15
Arts and Recreation Services	\$114.2	\$3.74	+3.28	\$21.32
Other Services	\$549.4	\$29.91	+5.44	\$63.72
<b>Total industries</b>	<b>\$15,368.4</b>	<b>\$1,953.15</b>	<b>+12.71</b>	<b>\$3,367.54</b>

Source: National Institute of Economic and Industry Research (NIEIR) ©2023. Compiled and presented in economy.id by .id (informed decisions).



## Operational phase



**\$1.73B**  
Output

(\$1.29B direct  
+ \$445M Indirect)



**\$888.4M**  
Value added (GRP)

(\$665.65M Direct  
+ \$223.20M Indirect)



**12,071**  
Local jobs

(9,223 Direct  
+ 2,848 Indirect)

**Infinity Planet Proposal - 13 Feb 2024 (based on jobs) in the Moreton Bay** is estimated **to support 9,223 direct local jobs per annum on an ongoing basis**. This would generate \$1.29B in direct output per year and \$665.65M in industry value added per year.

From this direct expansion in the economy, it is anticipated that there would be flow-on effects into other related intermediate industries as well as increased new employee consumption expenditure. These combined flow-on effects are estimated **to support another 2,848 indirect local jobs per year** and generate \$223.20M in indirect industry value added per year off the back of \$445M in output.

**The total estimated annual impact is 12,071 local jobs, \$1.73B in output and \$888.84M in value added (GRP).**



## Operational phase

### Moreton Bay – Modelling the annual effect (inflation adjusted) of:

- adding 928 jobs in Accommodation and Food Services
- adding 240 jobs in Administrative and Support Services
- adding 1340 jobs in Arts and Recreation Services
- adding 1000 jobs in Food and Beverage Services
- adding 150 jobs in Food Retailing
- adding 5400 jobs in Other Store-Based Retailing
- adding 90 jobs in Social Assistance Services
- adding 75 jobs in Transport, Postal and Warehousing

Economic measure	Output (\$m)	Value-added (\$m)	Local jobs	Residents jobs
<b>Impacts on Moreton Bay economy</b>	--	--	--	--
Direct impact on selected sector(s)	1,286.60	665.65	9,223	--
Industrial impact	233.26	119.91	1,724	--
Consumption impact	211.74	103.28	1,124	--
<b>Total impact on Moreton Bay economy</b>	<b>1,731.60</b>	<b>888.84</b>	<b>12,071</b>	<b>9,619</b>
<b>Multipliers</b>	--	--	--	--
Type 1 multiplier (direct and industrial)	1.18	1.18	1.19	--
Type 2 multiplier (direct, industrial and consumption)	1.35	1.34	1.31	--
<b>Impact on Queensland economy</b>	--	--	--	--
Total impact - Queensland outside Moreton Bay	510.68	242.71	1,911	3,547
<b>Total impact on Queensland economy</b>	<b>2,242.27</b>	<b>1,131.55</b>	<b>13,982</b>	<b>13,167</b>
<b>Impact on Australian economy</b>	--	--	--	--
Total impact outside Queensland economy	512.50	255.58	1,479	1,508
<b>Total impact on Australian economy</b>	<b>2,754.77</b>	<b>1,387.13</b>	<b>15,461</b>	<b>14,674</b>

Source: National Institute of Economic and Industry Research (NIEIR) ©2023. Compiled and presented in economy.id by .id (informed decisions). Note: All \$ values are expressed in 2019/20 base year dollar terms.



## Operational phase – Employment by industry sector

### Moreton Bay – Modelling the annual effect (inflation adjusted) of:

- adding 928 jobs in Accommodation and Food Services
- adding 240 jobs in Administrative and Support Services
- adding 1340 jobs in Arts and Recreation Services
- adding 1000 jobs in Food and Beverage Services
- adding 150 jobs in Food Retailing
- adding 5400 jobs in Other Store-Based Retailing
- adding 90 jobs in Social Assistance Services
- adding 75 jobs in Transport, Postal and Warehousing

Industry sector (1-digit ANSIC)	Existing jobs in the Moreton Bay	Jobs created in the Moreton Bay	Jobs created outside of the Moreton Bay	Jobs created for the Moreton Bay residents
Agriculture, Forestry and Fishing	3,365	140.4	136.2	119.2
Mining	818	3.8	25.9	3.3
Manufacturing	10,399	183.6	257.4	147.4
Electricity, Gas, Water and Waste Services	1,511	30.0	65.1	25.0
Construction	18,213	122.2	80.3	96.1
Wholesale Trade	3,391	86.1	124.9	70.6
Retail Trade	21,730	6011.9	325.6	4643.3
Accommodation and Food Services	12,159	2222.0	296.5	1830.5
Transport, Postal and Warehousing	6,354	206.9	175.1	173.5
Information Media and Telecommunications	1,037	33.1	132.1	30.1
Financial and Insurance Services	2,968	87.7	257.0	75.8
Rental, Hiring and Real Estate Services	3,005	199.4	75.8	165.4
Professional, Scientific and Technical Services	6,986	301.1	485.7	256.5
Administrative and Support Services	5,179	462.1	161.9	371.8
Public Administration and Safety	6,501	19.0	57.4	16.7
Education and Training	17,117	167.8	196.1	136.2
Health Care and Social Assistance	28,451	206.4	240.6	173.4
Arts and Recreation Services	1,822	1438.3	132.4	1154.0
Other Services	7,832	149.4	162.9	130.1
<b>Total industries</b>	<b>158,837</b>	<b>12,071</b>	<b>3,389</b>	<b>9,619</b>

Source: National Institute of Economic and Industry Research (NIEIR) ©2023. Compiled and presented in economy.id by .id (informed decisions).





## Operational phase – Employment by industry sector

Moreton Bay – Modelling the annual effect (inflation adjusted) of:

- adding 928 jobs in Accommodation and Food Services
- adding 240 jobs in Administrative and Support Services
- adding 1340 jobs in Arts and Recreation Services
- adding 1000 jobs in Food and Beverage Services
- adding 150 jobs in Food Retailing
- adding 5400 jobs in Other Store-Based Retailing
- adding 90 jobs in Social Assistance Services
- adding 75 jobs in Transport, Postal and Warehousing

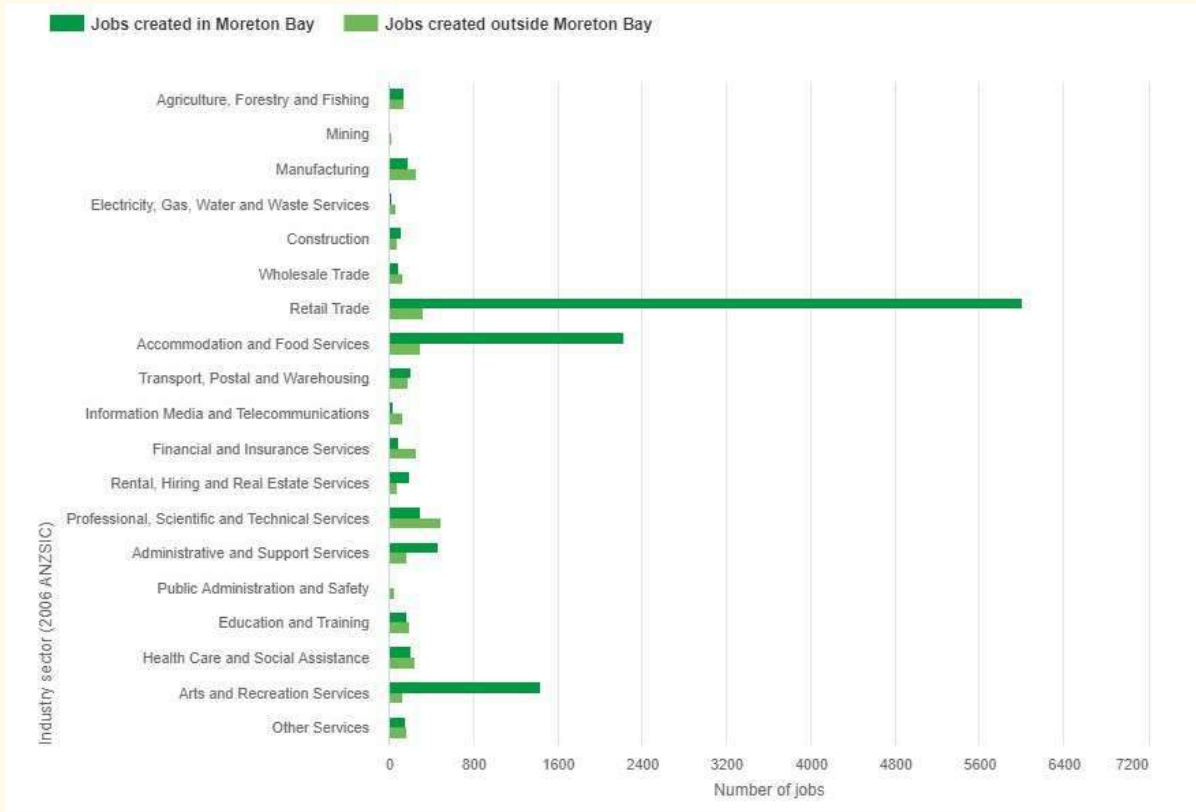

Source: National Institute of Economic and Industry Research (NIEIR) ©2023. Compiled and presented in economy.id by .id (informed decisions).



## Operational phase – Value added by industry sector

### Moreton Bay – Modelling the impact on value added of:

- adding 928 jobs in Accommodation and Food Services
- adding 240 jobs in Administrative and Support Services
- adding 1340 jobs in Arts and Recreation Services
- adding 1000 jobs in Food and Beverage Services
- adding 150 jobs in Food Retailing
- adding 5400 jobs in Other Store-Based Retailing
- adding 90 jobs in Social Assistance Services
- adding 75 jobs in Transport, Postal and Warehousing

Industry sector (1-digit ANSIC)	Value Added \$m	Value added \$m to the Moreton Bay	Percentage change	Value added \$m to Australian economy
Agriculture, Forestry and Fishing	\$488.8	\$19.94	+4.08	\$44.42
Mining	\$84.8	\$0.28	+0.33	\$12.38
Manufacturing	\$1,227.5	\$19.98	+1.63	\$53.21
Electricity, Gas, Water and Waste Services	\$460.0	\$9.85	+2.14	\$29.80
Construction	\$2,010.2	\$12.48	+0.62	\$21.93
Wholesale Trade	\$622.5	\$16.03	+2.58	\$42.79
Retail Trade	\$1,497.3	\$404.09	+26.99	\$429.70
Accommodation and Food Services	\$499.1	\$91.96	+18.42	\$107.33
Transport, Postal and Warehousing	\$775.2	\$23.59	+3.04	\$50.82
Information Media and Telecommunications	\$155.6	\$5.76	+3.70	\$37.41
Financial and Insurance Services	\$722.6	\$22.52	+3.12	\$110.75
Rental, Hiring and Real Estate Services	\$632.6	\$42.32	+6.69	\$61.77
Professional, Scientific and Technical Services	\$869.9	\$36.87	+4.24	\$105.79
Administrative and Support Services	\$603.3	\$55.89	+9.26	\$86.64
Public Administration and Safety	\$724.8	\$2.07	+0.29	\$8.60
Education and Training	\$1,141.4	\$9.19	+0.81	\$26.21
Health Care and Social Assistance	\$2,189.2	\$15.92	+0.73	\$35.55
Arts and Recreation Services	\$114.2	\$89.65	+78.52	\$99.91
Other Services	\$549.4	\$10.47	+1.91	\$22.05
<b>Total industries</b>	<b>\$15,368.4</b>	<b>\$888.84</b>	<b>+5.78</b>	<b>\$1,387.06</b>

Source: National Institute of Economic and Industry Research (NIEIR) ©2023. Compiled and presented in economy.id by .id (informed decisions).





## Operational phase – Value added by industry sector

### Moreton Bay – Modelling the impact on value added of:

- adding 928 jobs in Accommodation and Food Services
- adding 240 jobs in Administrative and Support Services
- adding 1340 jobs in Arts and Recreation Services
- adding 1000 jobs in Food and Beverage Services
- adding 150 jobs in Food Retailing
- adding 5400 jobs in Other Store-Based Retailing
- adding 90 jobs in Social Assistance Services
- adding 75 jobs in Transport, Postal and Warehousing

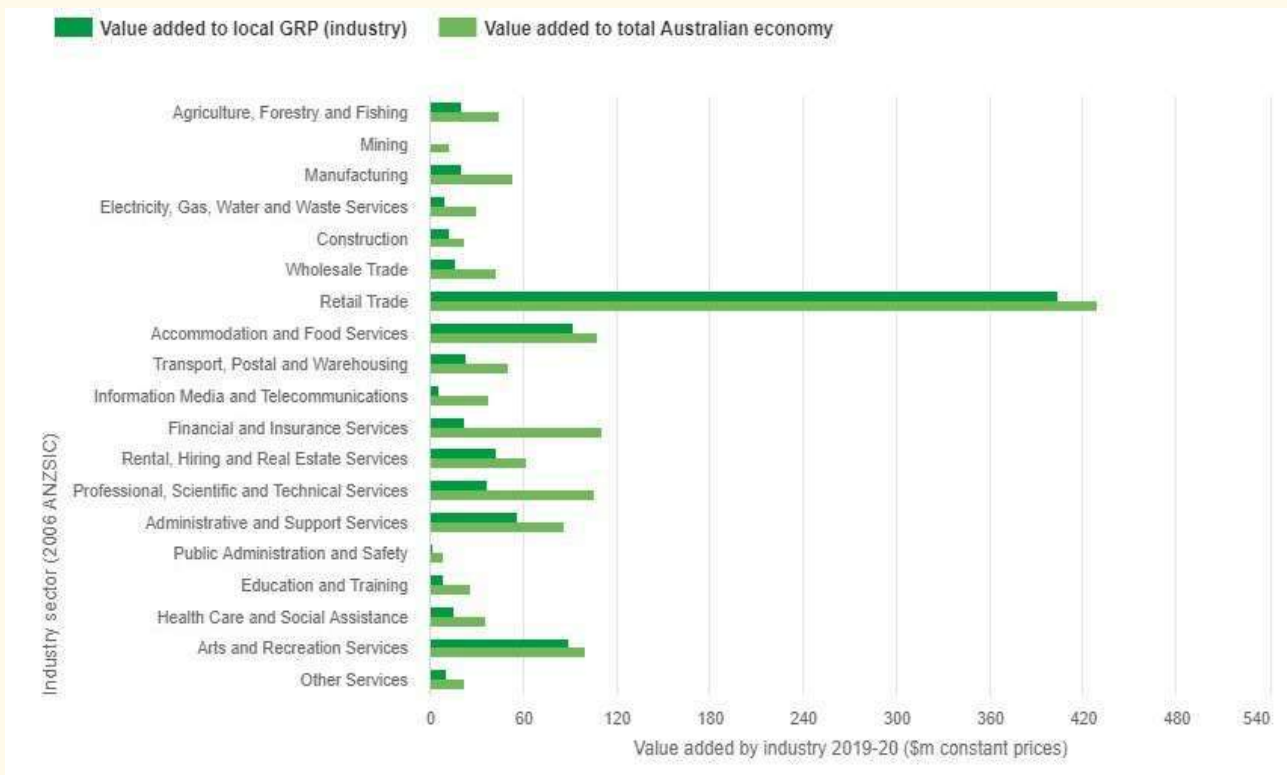

Source: National Institute of Economic and Industry Research (NIEIR) ©2023. Compiled and presented in economy.id by .id (informed decisions).



# *Social and Cultural Impact*





## **Skill Development and Training**

- Hospitality and Service Industry Training
- Tourism Management
- Event Planning
- Health and Safety

## **Cultural Exchange and Awareness**

- Cultural Heritage and Preservation
- Global Presentation to representatives from more than 50 countries
- Cultural Performance
- Cultural Pavilions
- Educational Workshops
- Community Engagement





# **THE** *Master Plan*





# IPC *Size of Development*



## *Australia's biggest Theme park & Hotel Global Heritage City with 20 concept areas*



*City of Moreton Bay, Queensland, Australia*

<b>Total Land</b>	<b>666,700</b>	<b>100%</b>
<b>Landscapes, Roads, Pools</b>	<b>356,340</b>	<b>53%</b>
<b>Gross Development Areas</b>	<b>310,360</b>	<b>47%</b>
<b>Car Park (Land)</b>	<b>31,650</b>	<b>5%</b>
<b>Gross Built up Areas</b>	<b>672,952</b>	<b>101%</b>
<b>Income Generation</b>	<b>352,980</b>	<b>53%</b>

# IPC *Ring Road*



**New Road - RHC Ring Road**

**New road – RHC Car Free Road**



9,500 capacity carpark  
in four different zones

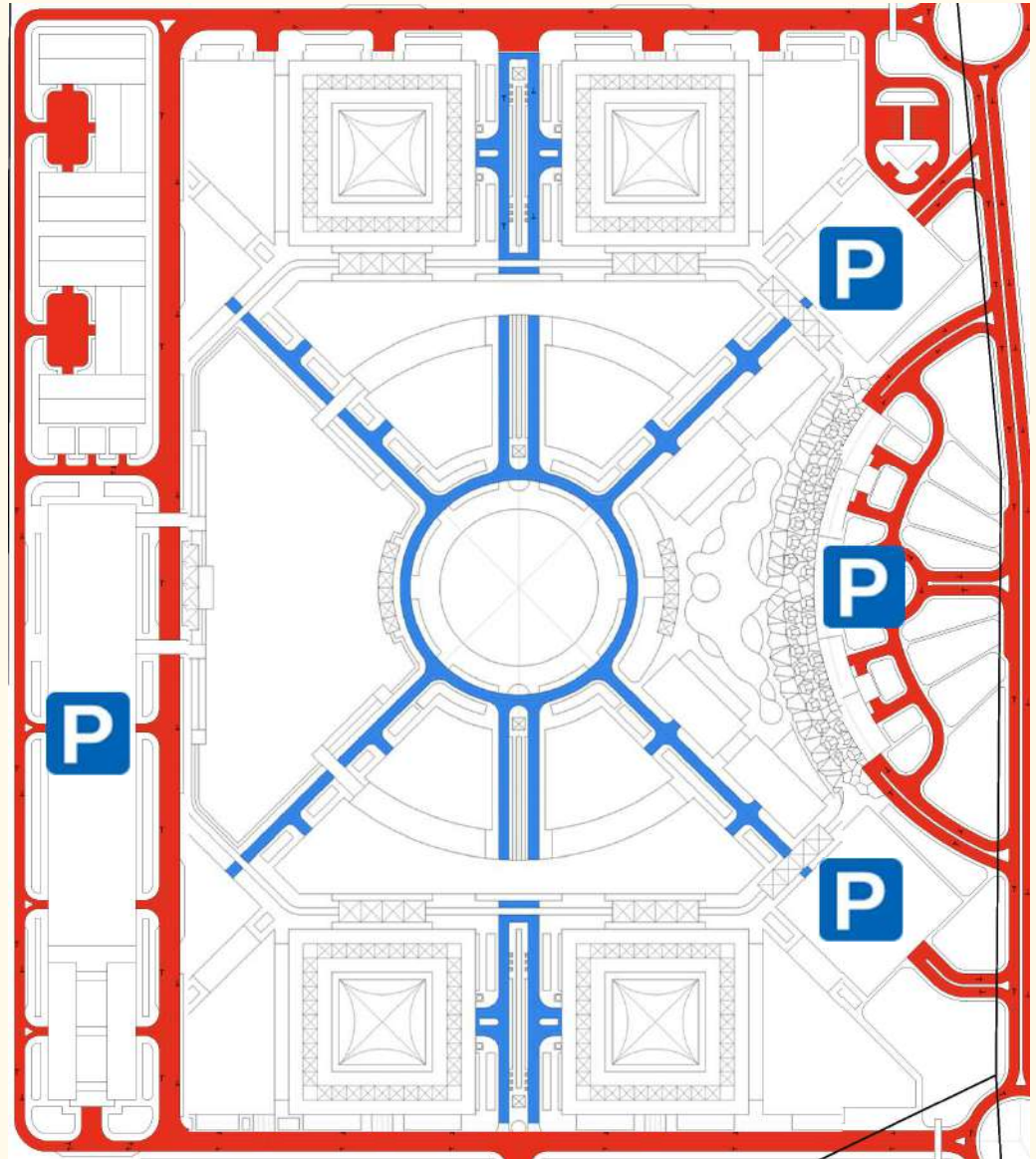



# IPC *Electric Train*



*Electric Train*

2.8 KM Distance  
25 to 30 min.  
with 7 station stop



**Tram San Francisco**

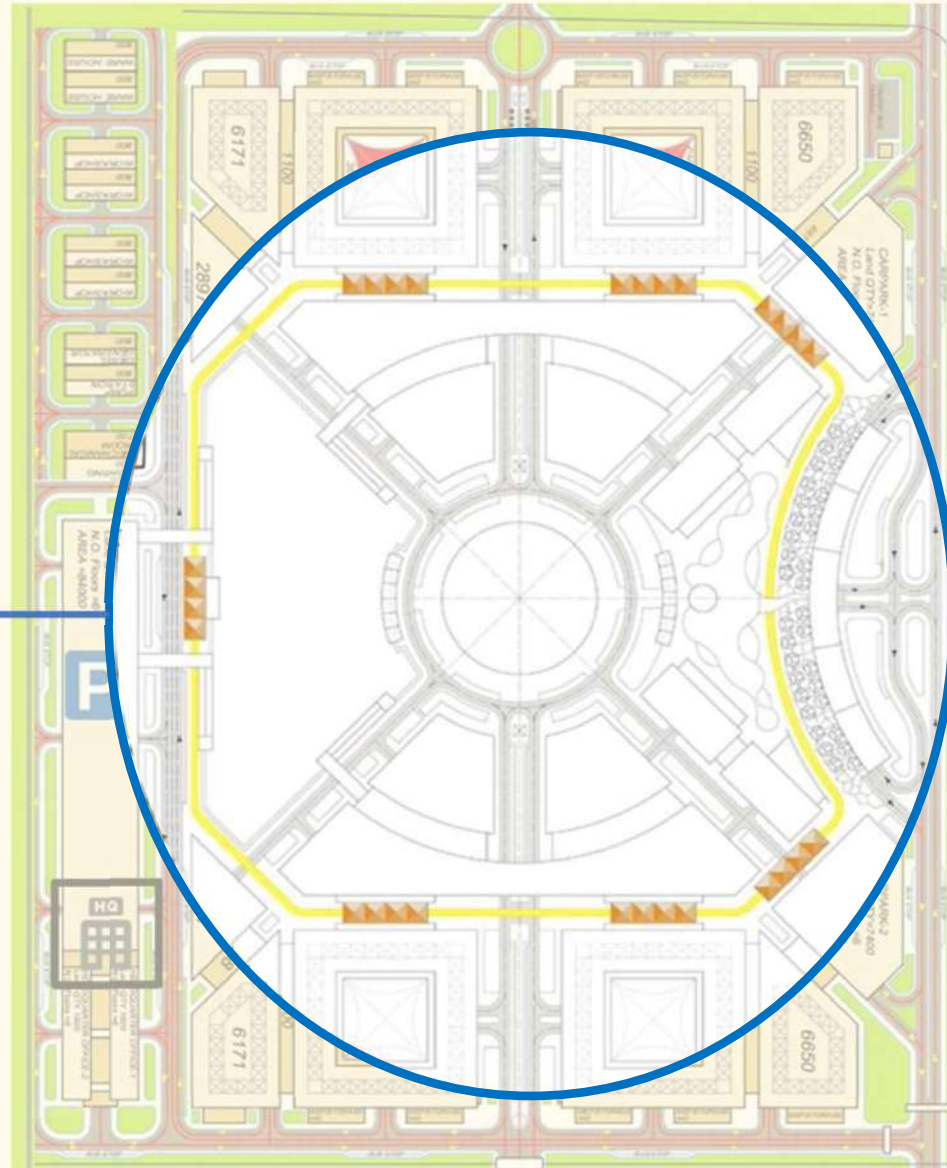

# IPC Industrial Park and Office

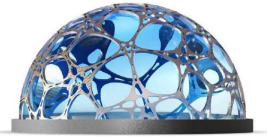

INFINITY PLANET

Global Heritage City - Queensland, Australia



Building Facilities,  
Warehouse & Storage  
Recycling Centre,  
Recycling Water



Office

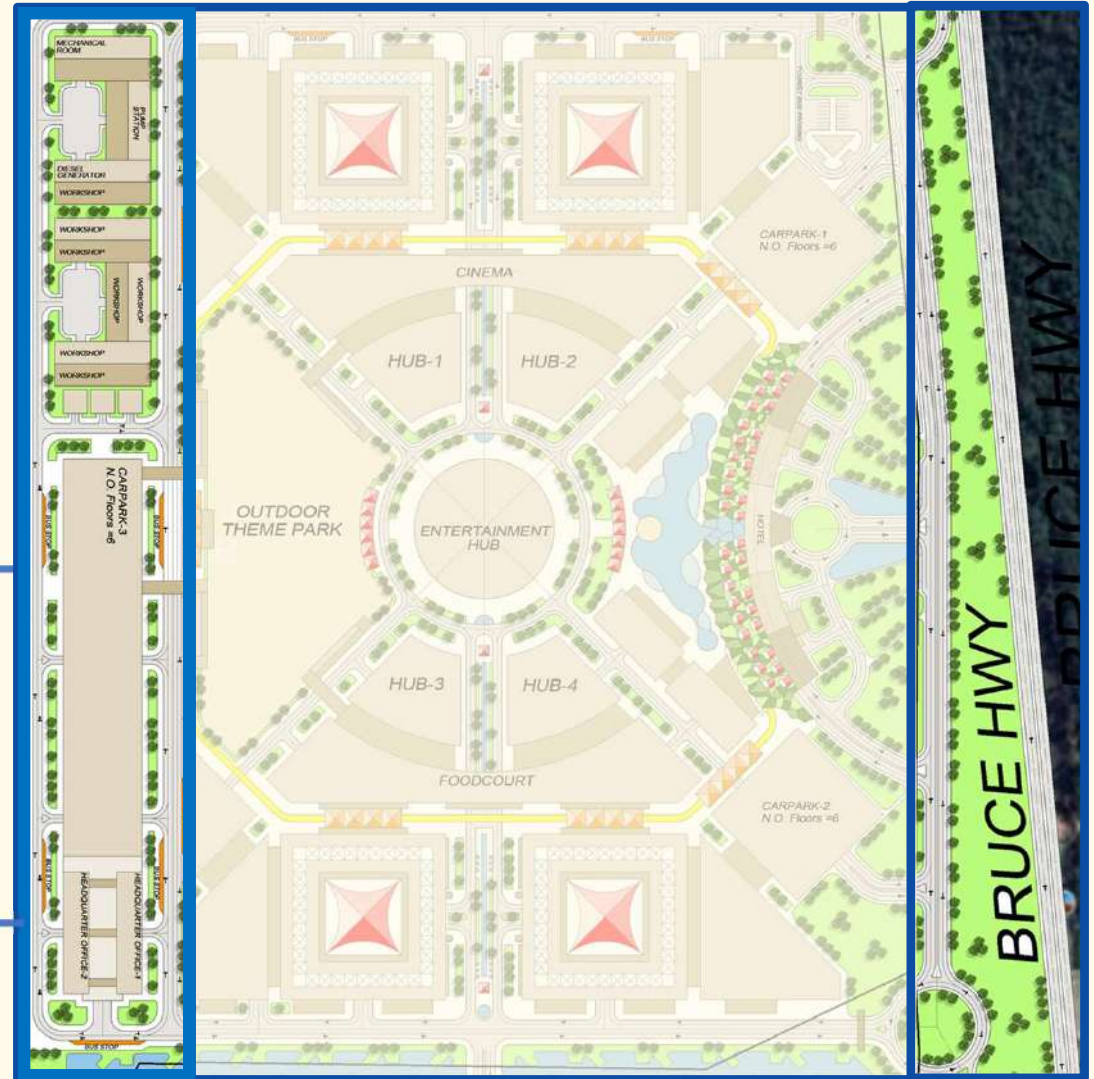



# Infinity Planet Green & Sustainable City

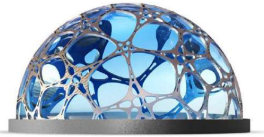

FUTURE CITY

Zero Carbon & Smart City  
Green & Sustainable City  
Car Free Zone, A-EV Shuttle, Walkability





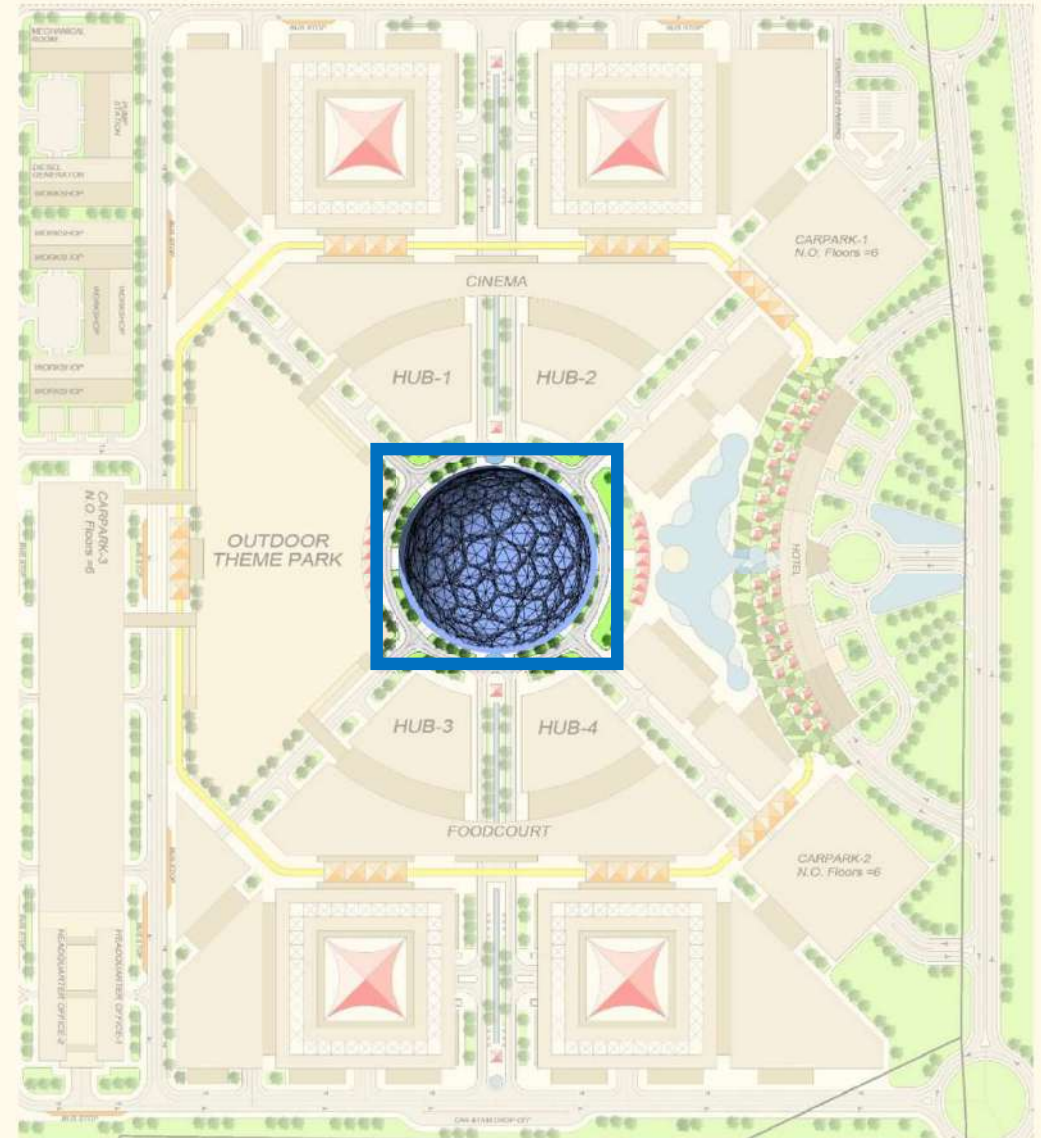
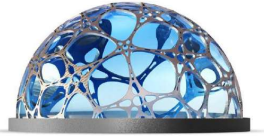



# Infinity Planet New Generation of Theme Park

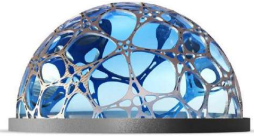

INFINITY PLANET

Global Heritage City - Queensland, Australia

- Storytelling Experience
- VR,AR,MR
- Edutainment & Learning
- Themed Lands & Zones
- Health & Sustainability
- Personal Experience
- Window Shopping
- Live Entertainment
- Integration of IP
- Multi-Sensory Experiences
- E-Reservation- Digital Line

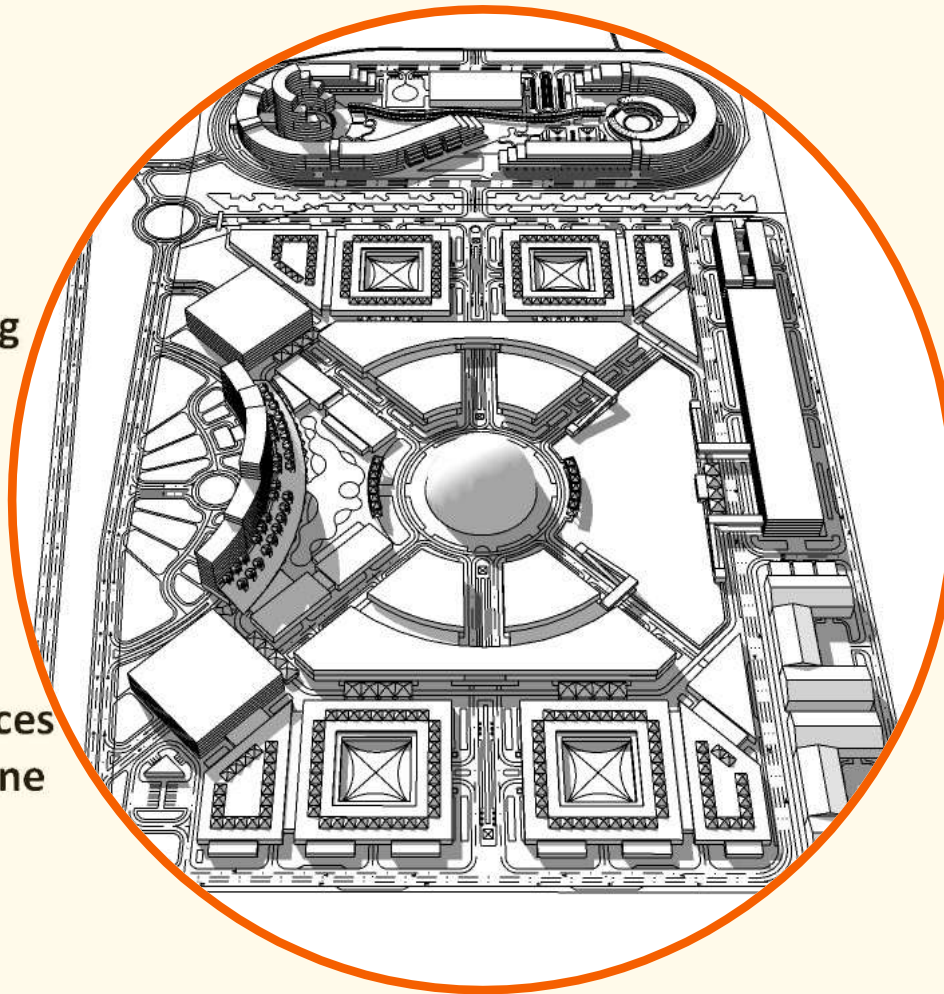

Storytelling Experience



VR, AR, MR



Edutainment & Learning



Interactivity Game



Themed Lands & Zones



Health & Sustainability



personal experience



Window Shopping



Live Entertainment



Integration of IP



Multi-Sensory Experiences



eReservation.Digital Line

## New Generation of Theme Park

Indoor Theme Park  
Sustainability World  
Innovation Centre  
Under water life

 Storytelling Experience	 VR, AR, MR
 Edutainment & Learning	 Interactivity Game
 Themed Lands & Zones	 Health & Sustainability
 personal experience	 Window Shopping
 Live Entertainment	 Integration of IP
 Multi-Sensory Experiences	 eReservation.Digital Line



Indoor Theme Park  
Sustainability World  
Innovation Centre  
Under water life





# IPC Outdoor Theme Park

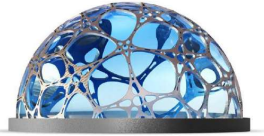

INFINITY PLANET

Global Heritage City - Queensland, Australia

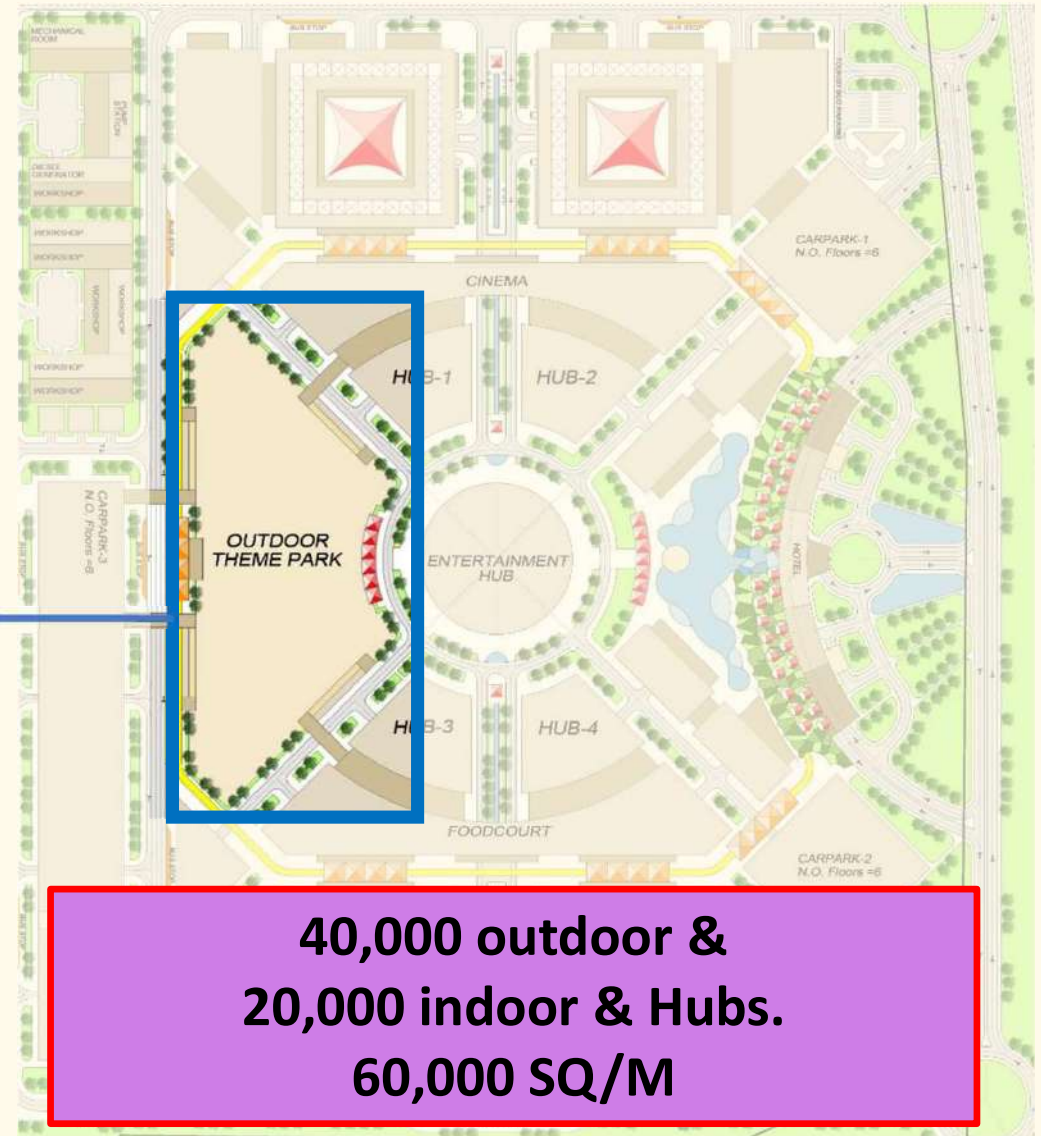
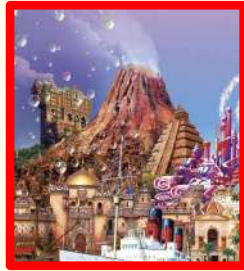

40,000 outdoor &  
20,000 indoor & Hubs.  
60,000 SQ/M





# IPC Landmark Areas



Brandenburg Gate,  
Germany

7

5



Parthenon, Athens,  
Greece

3



Eiffel Tower - France

1



Colosseum, Italia

6



De Haar Castle,  
Netherlands

4



La Sagrada Familia,  
Spain

2



St. Basils Cathedral  
Russia

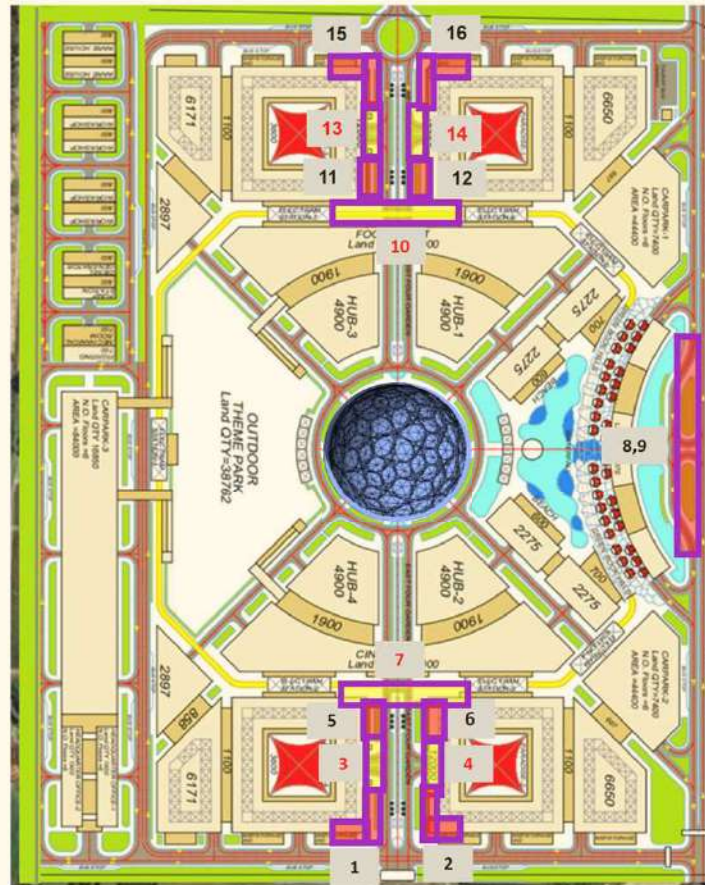

8,9



World Face

10



Persepolis - Iran

11



Petra, Jordan

12



Rohtas Fort,  
Pakistan

13



Grand Palace,  
Bangkok,  
Thailand



Fort Santiago  
(Kuta ng  
Santiago)  
Philippines

15



Taj Mahal - India

16



The Great Pyramid  
of Giza - Egypt



# IPC Landmark Areas

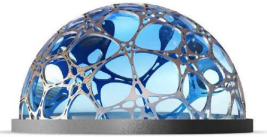

INFINITY PLANET

Global Heritage City - Queensland, Australia



- Taj Mahal – India
- Colosseum – Italia
- Eiffel Tower – France
- St. Basils Cathedral – Russia
- Big Ben – UK
- La Sagrada Familia – Spain
- Hagia Sophia – Turkey



- Leaning Tower of Pisa – Italy
- The Great Pyramid of Giza – Egypt
- The Statue of Liberty – America
- Opera House – Australia
- The Brandenburg Gate – Germany
- Persepolis – Iran
- Christ the Redeemer (statue) – Brazil





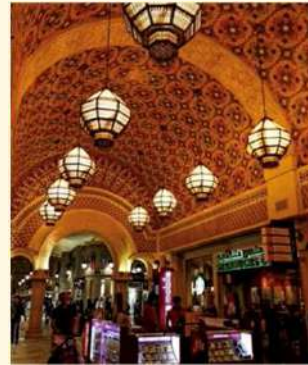
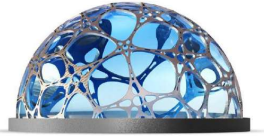

*Historic Market Hall*

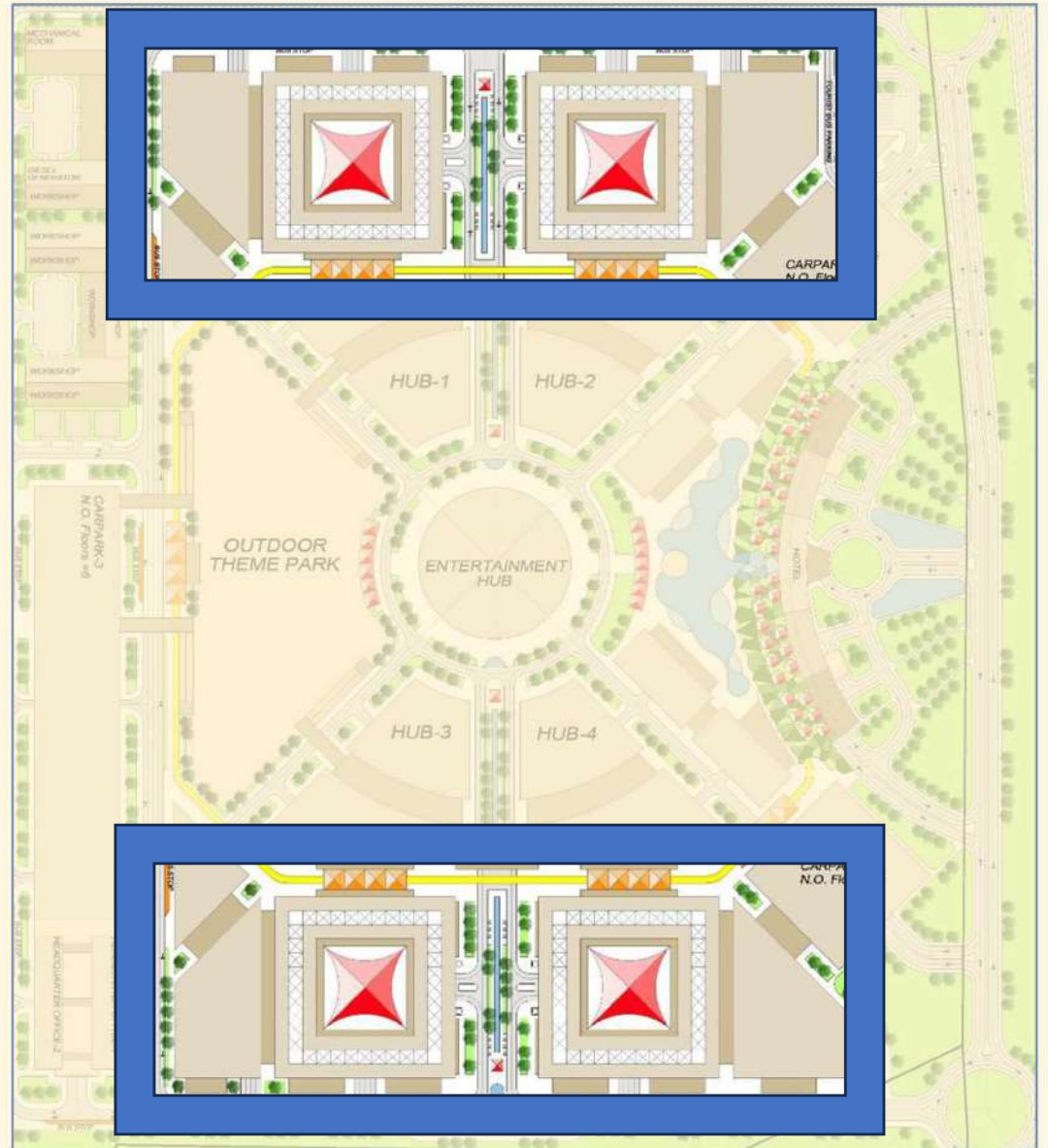



# IPC *Modern City Centre*

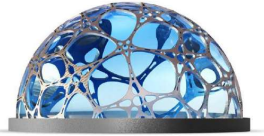

**INFINITY PLANET**  
Global Heritage City - Queensland, Australia

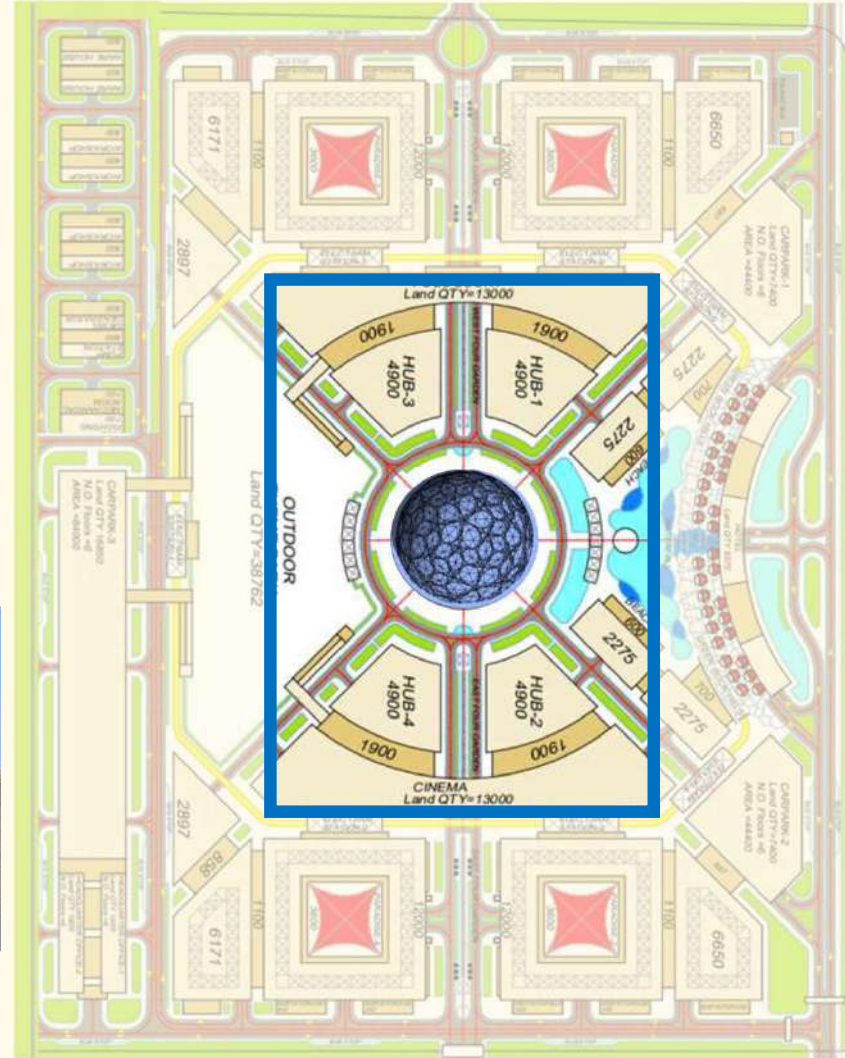

# IPC *Landscape, Water fountain, Walking area*

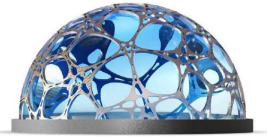

**INFINITY PLANET**  
Global Heritage City - Queensland, Australia



<b>TOTAL LAND</b>	<b>666,700</b>	<b>100%</b>
Landscapes, Roads, Pools	374,003	56%
Gross Development Areas	292,698	44%
Car Park (Land)	31,650	5%
Gross Built Up Areas	630,282	95%
Income generation	325,080	49%



# IPC *Four Paradise*

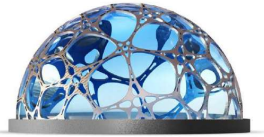

INFINITY PLANET  
Global Heritage City - Queensland, Australia



European Landscape



Chinese Landscape

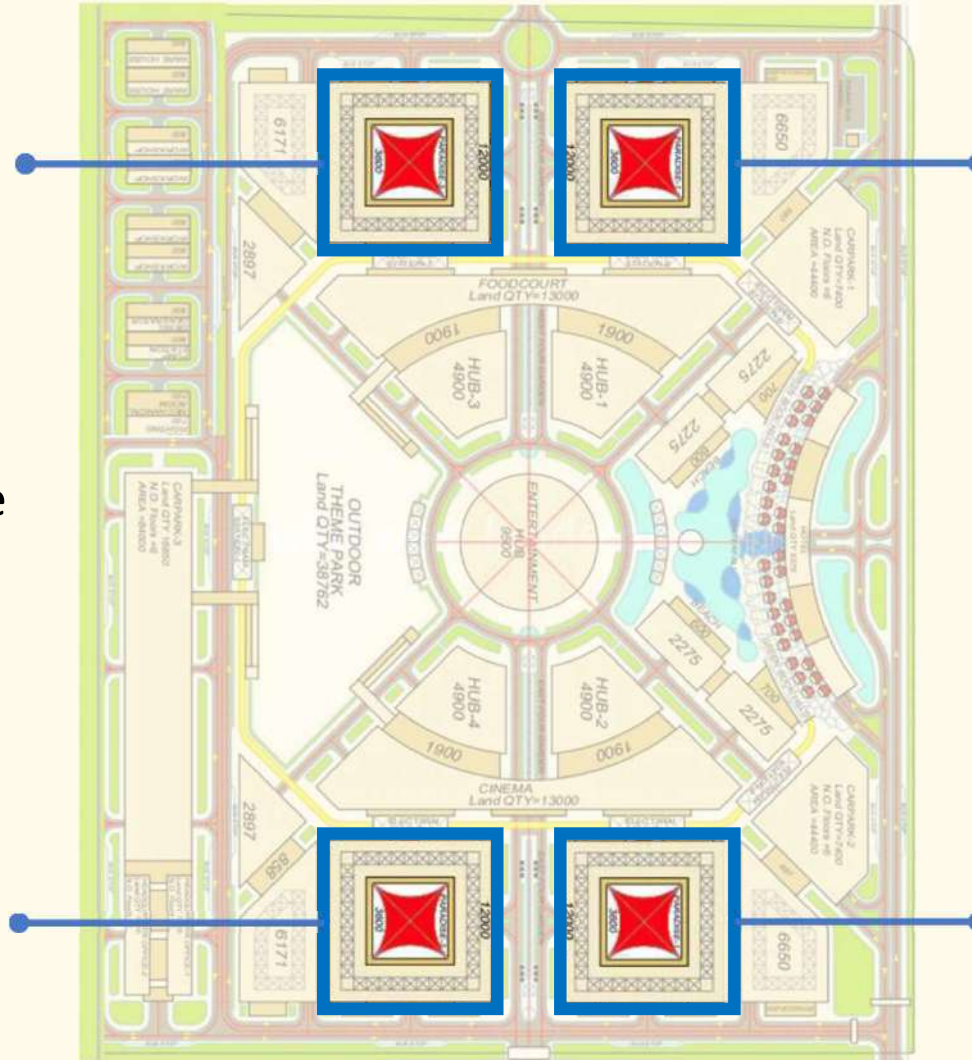

Japanese Garden



Wild West Landscape



# IPC *Four Gardens Avenue*



## Chahar Bagh Avenue



## Rambla de Catalunya

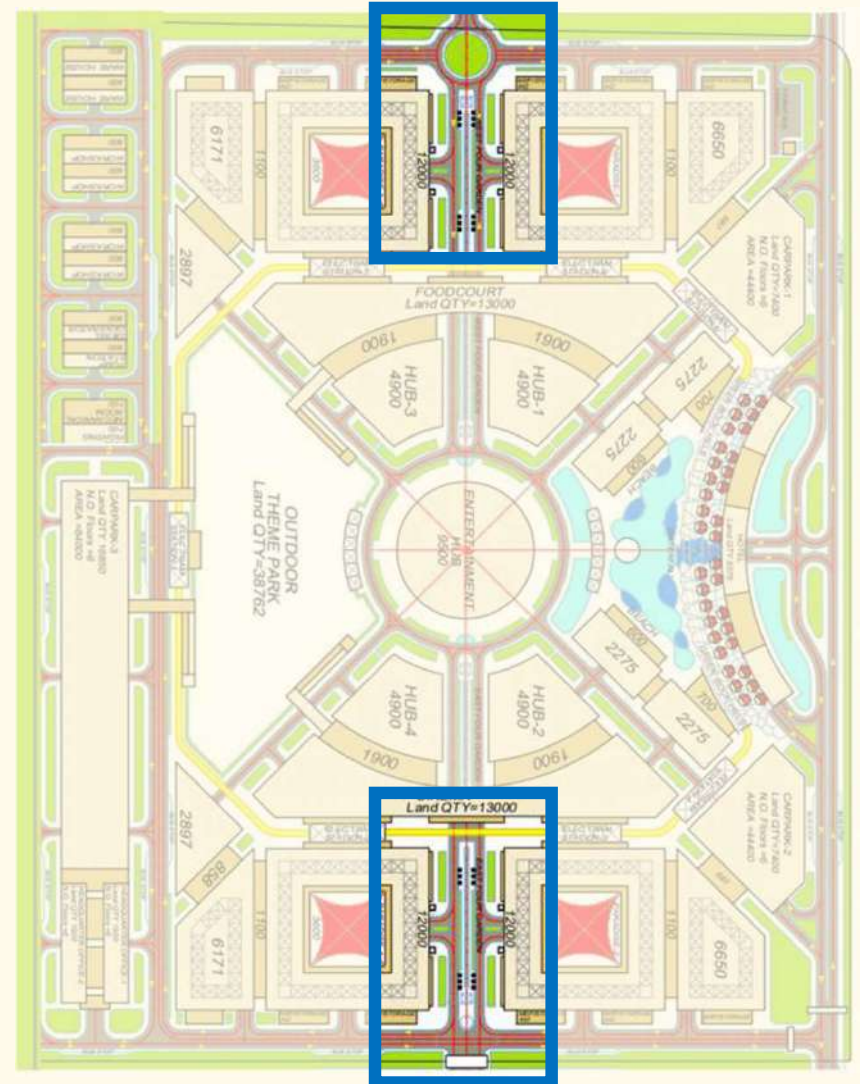



# IPC *Beach and Waterfall*

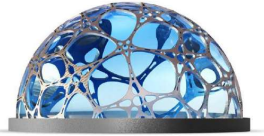

**INFINITY PLANET**  
Global Heritage City - Queensland, Australia



*The length of South Bank*

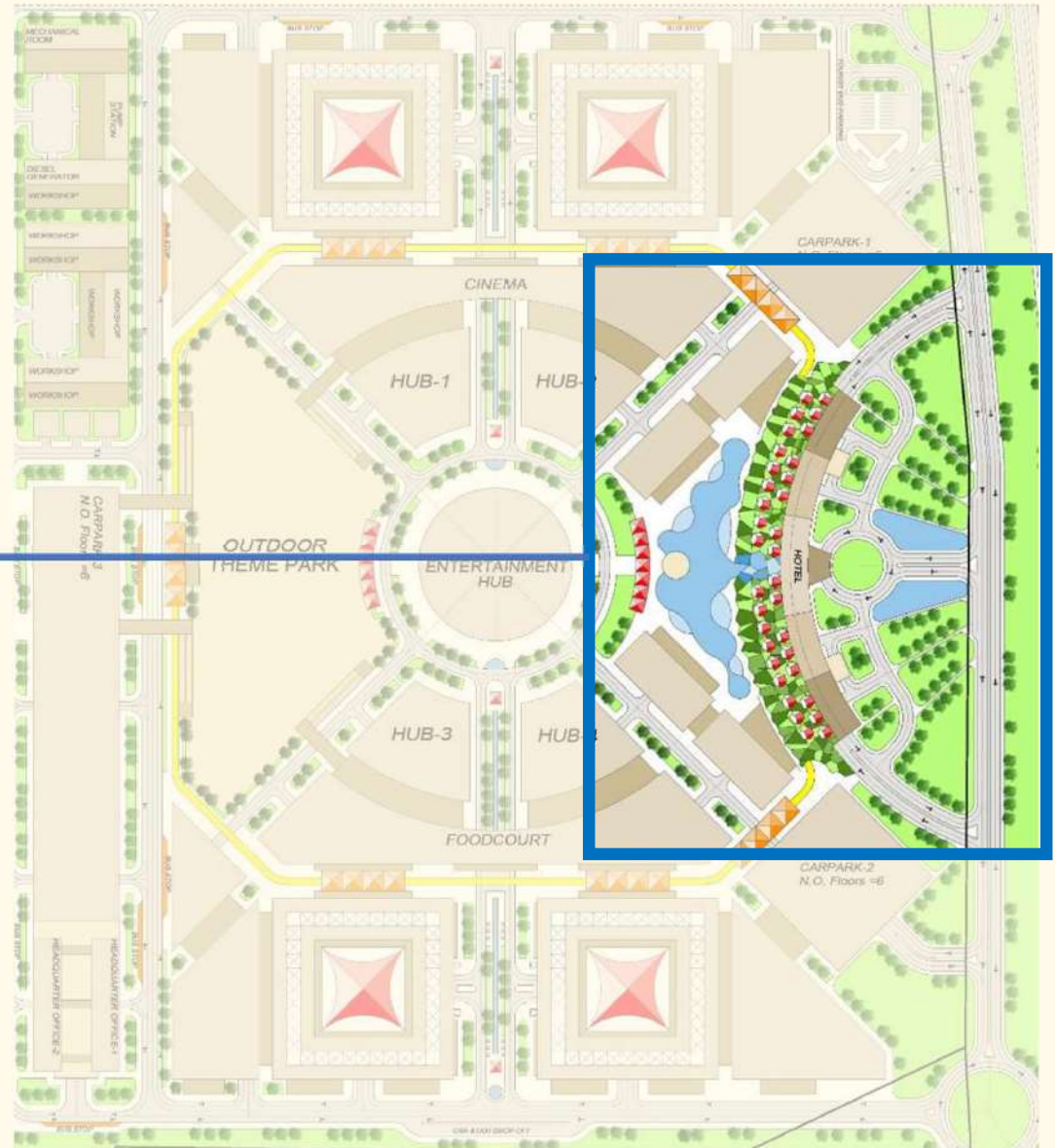

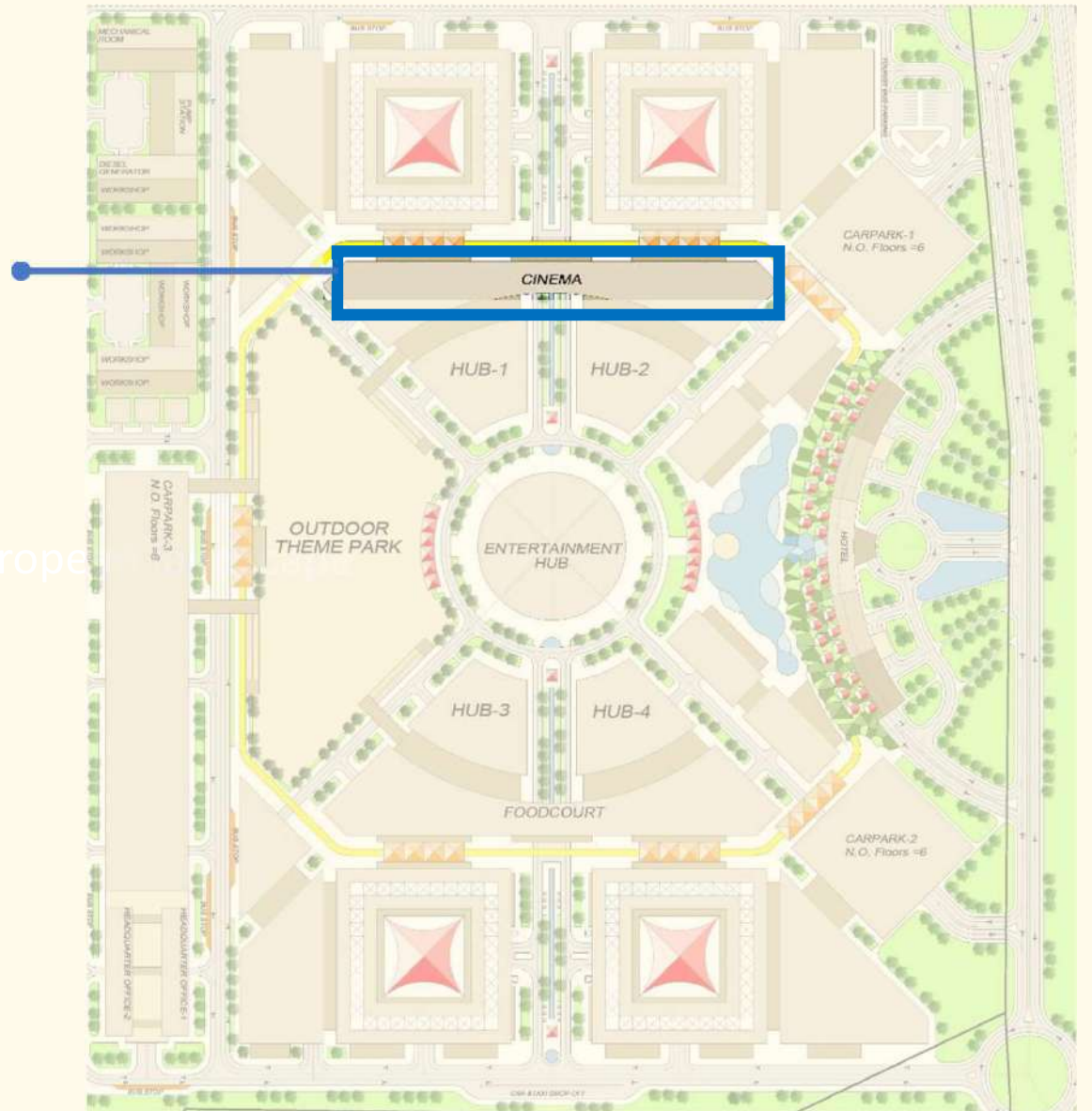
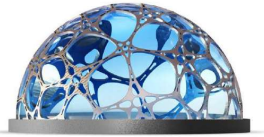



# IPC *International Food Court*

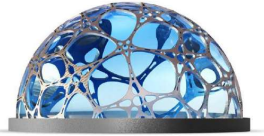

**INFINITY PLANET**  
Global Heritage City - Queensland, Australia

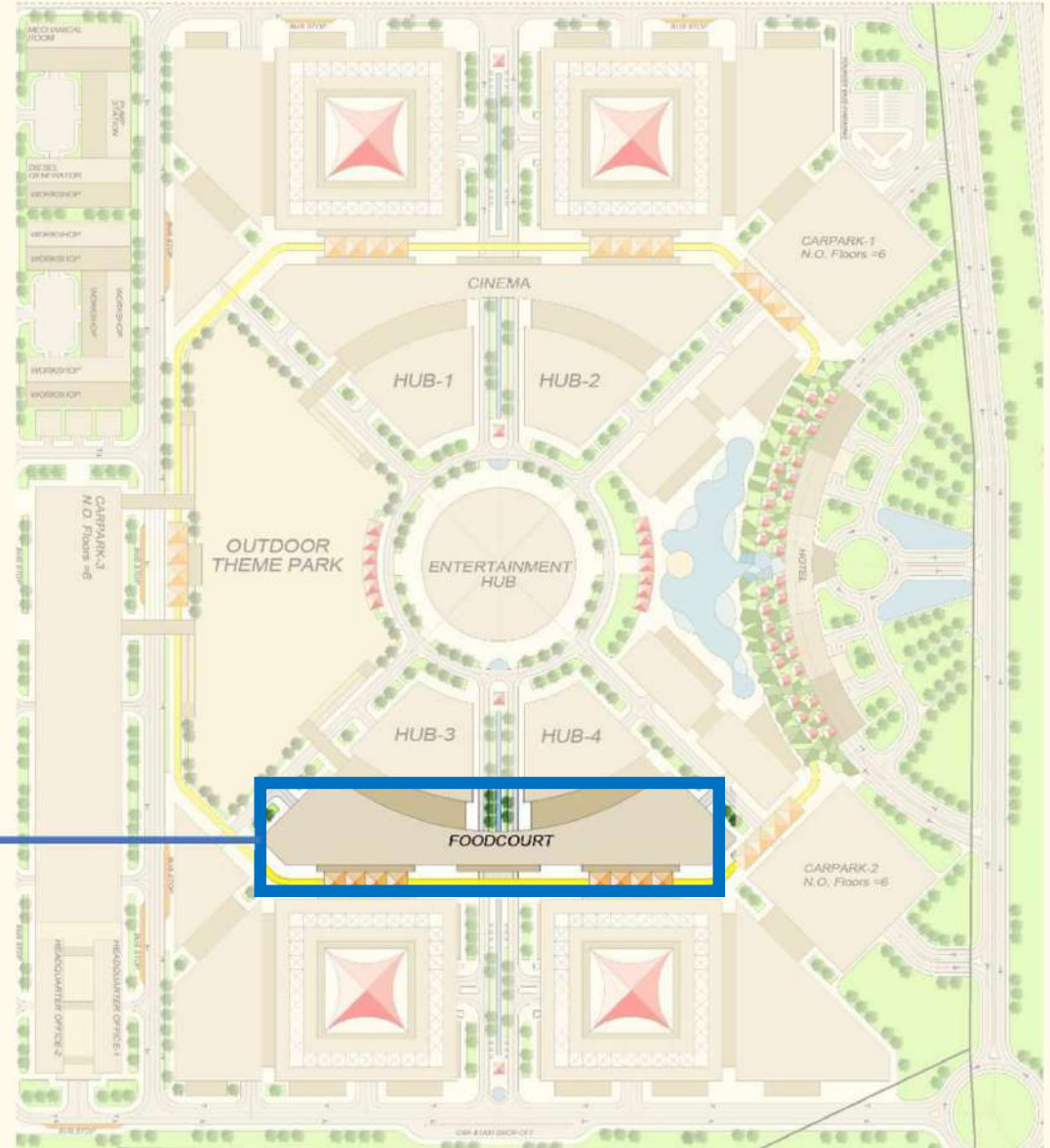



# IPC Accommodation Centre A





# IPC Accommodation Centre B

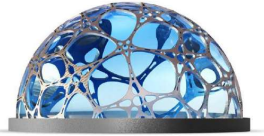

**INFINITY PLANET**  
Global Heritage City - Queensland, Australia



**Luxury Units Apartment  
4 Star Hotel  
Hotel Apartment  
Staff Residential Building**



## Accommodation A & B

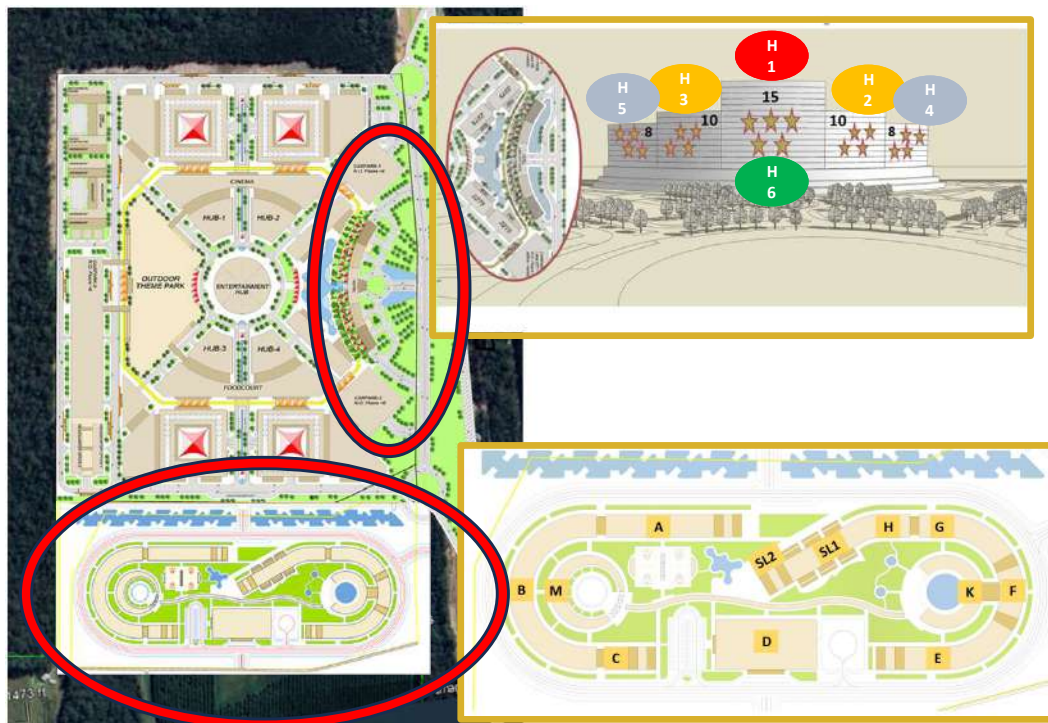

Accommodation A	Land	Levels	Units/Level	Units	Area/Unit	Rooms
H1 (5 Star)	1,137.50	15	14	210	60	420
H2 (4 Star)	1,137.50	10	14	140	60	280
H3 (4 Star)	1,137.50	10	14	140	60	280
H4 (4 Star)	1,137.50	8	14	112	60	224
H5 (4 Star)	1,137.50	8	14	112	60	112
H6 (5 Star Camping)	5,000.00	1	50	50	50	50
	<b>10,687.50</b>			<b>764</b>		<b>1,366</b>

Accommodation B	Land	Levels	Units/Level	Units	Area/Unit	Rooms
Accommodation Units Block A	5,200.00	4	52	208	80	416
Accommodation Units Block B	5,200.00	4	52	208	80	416
Luxury Accommodation Units Block C L1,2	2,160.00	2	15	30	144	90
Luxury Accommodation Units Block C L3,4	-	2	15	30	144	90
Super Luxury Accommodation Units Block D L1,2	4,680.00	2	26	52	180	720
Super Luxury Accommodation Units Block D L3,4	-	1	13	13	270	52
Luxury Accommodation Units Block E L1,2	2,160.00	2	15	30	144	60
Luxury Accommodation Units Block E L3,4	-	2	15	30	144	60
	<b>19,400.00</b>			<b>601</b>		<b>1,940</b>

Accommodation A & B	Units	Rooms
Accommodation A	764	1,366
Accommodation B	601	1,940
<b>Total</b>	<b>1,365</b>	<b>3,306</b>



# IPC *Size of Development*



<b>Total Land</b>	<b>666,700</b>	<b>100%</b>
<b>Landscapes, Roads, Pools</b>	<b>356,340</b>	<b>53%</b>
<b>Gross Development Areas</b>	<b>310,360</b>	<b>47%</b>
<b>Car Park (Land)</b>	<b>31,650</b>	<b>5%</b>
<b>Gross Built up Areas</b>	<b>672,952</b>	<b>101%</b>
<b>Income Generation</b>	<b>352,980</b>	<b>53%</b>



***Australia's biggest  
Theme Park & Hotel  
Global Heritage City  
with 20 concept areas***

## TOTAL AREAS

	Land	Built Up	Sellable
Grade A – Retail	36,600	41,360	28,320
Grade B – Retail	81,600	83,000	61,320
Grade C – Retail	48,026	41,556	34,276
Entertainment Hub	9,500	9,500	9,500
Indoor Entertainment		19,600	19,600
Outdoor Entertainment	38,762	38,762	38,762
Hotel – 5 stars	1,138	17,063	12,600
Hotel – 4 stars	4,550	40,950	30,240
Hotel Pool	4,200		
Camping – 5 Stars	5,000	2,500	2,500
Super luxury accommodation Units L1, 2	4,680	9,360	9,360
Super luxury accommodation Units L3, 4		4,680	3,510
Luxury accommodation Units L1, 2	4,320	8,640	8,640
Luxury accommodation Units L3, 4		8,640	8,640
Accommodation units Towers A, B	10,400	41,600	33,280
Industries	6,100	6,100	6,100
Office	3,840	23,040	18,432
Car Park	31,650	227,400	
Roads	89,724		
Tram Line	8,350		
Public facilities	3,880	3,880	
Public pools	6,100		
Meps/Storage	2,652	2,652	
	<b>401,072</b>	<b>630,282</b>	<b>325,080</b>





Tel: +61 731 621 162  
Email: [info@rhccity.com.au](mailto:info@rhccity.com.au)  
Address: Level 38, 71 Eagle street  
Brisbane 4000 Queensland, Australia  
[info@infinityplanet.com.au](mailto:info@infinityplanet.com.au)  
[www.infinityplanet.com.au](http://www.infinityplanet.com.au)

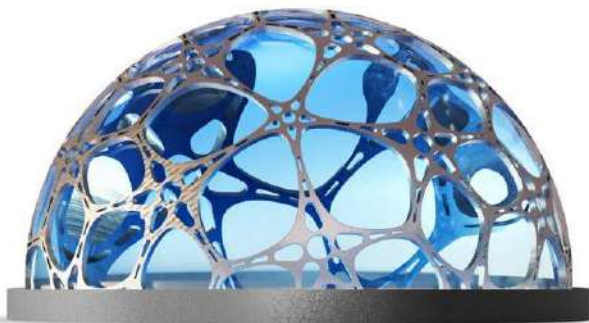

**INFINITY PLANET**  
Global Heritage City - Queensland, Australia

Master Developer



**RHC City Pty. Ltd.**  
[www.rhccity.com.au](http://www.rhccity.com.au)